



YARD FORCE®

OUTDOOR POWER EQUIPMENT

YF3100ES-R

Y0GWB31EW00

GAS PRESSURE WASHER

Operator's Manual

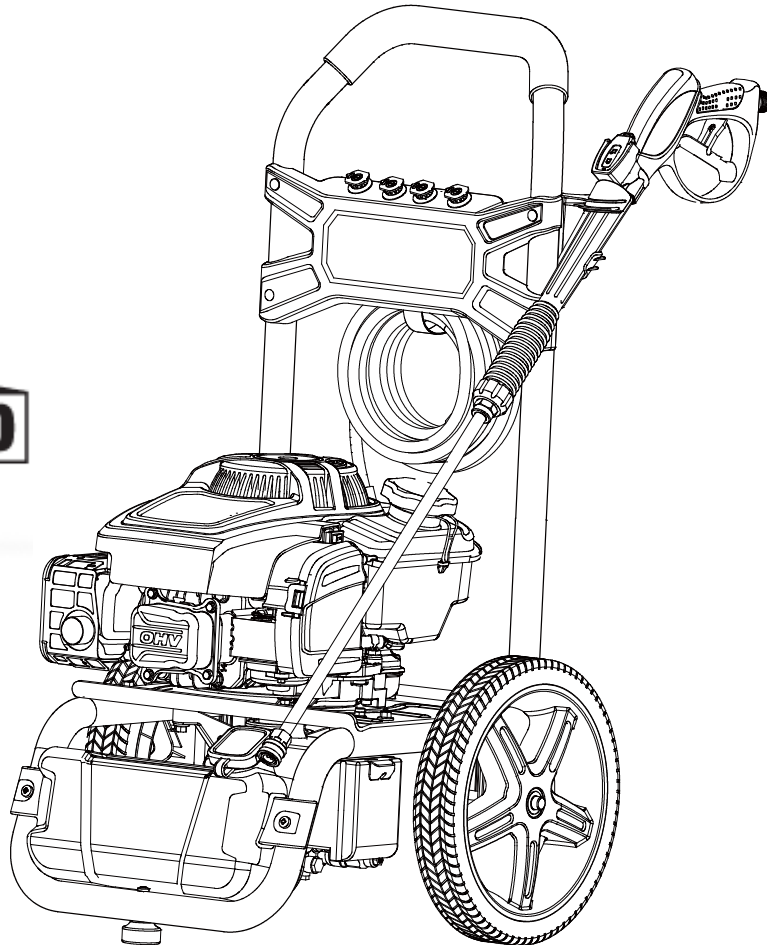

*Our Customer Service staff is ready to provide assistance.
In the case of a damaged or missing part, most replacement parts ship from our facility.*

For immediate help with assembly, or for additional product information, visit www.YardForceUSA.com or email support@MerotecUSA.com

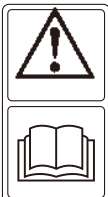

SAVE THIS MANUAL FOR REFERENCE

You will need this manual for safety instructions, operating procedures, and Warranty. The original sales receipt is required for warranty service.

TABLE OF CONTENTS

Safety Rules	3
Features And Controls	6
Assembly	7
Operation	11
Specifications	15
Maintenance	16
Storage	21
Troubleshooting	22
Warranty	23

SAFETY RULES



Read this manual carefully and become familiar with your pressure washer. Know its applications, its limitations, and any hazards involved.

Important Safety Information

Safety Symbols and Meanings



Operator's Manual



Toxic Fumes



Electrical Shock



Slippery Surface



Fall



Fluid Injection



Fire



Explosion



Kickback



Projectile



Moving Parts



Flying Objects



Chemical Burn



Hot Surface

The safety alert symbol indicates a potential personal injury hazard. A signal word (DANGER, WARNING, or CAUTION) is used with the alert symbol to designate a degree or level of hazard seriousness. A safety symbol may be used to represent the type of hazard. The signal word NOTICE is used to address practices not related to personal injury.

DANGER indicates a hazard which, if not avoided, will result in death or serious injury.

WARNING indicates a hazard which, if not avoided, could result in death or serious injury.

CAUTION indicates a hazard which, if not avoided, could result in minor or moderate injury.

NOTICE address practices not related to personal injury.

WARNING The engine exhaust from this product contains chemicals known to the State of California to cause cancer, birth defects, or other reproductive harm.

WARNING This product contains lead and lead compounds, known to the State of California to cause birth defects or other reproductive harm. Wash your hands after handling this product.

WARNING POISONOUS GAS HAZARD.



Engine exhaust contains carbon monoxide, a poisonous gas that could kill you in minutes. You CANNOT smell it, see it, or taste it. Even if you do not smell exhaust fumes, you could still be exposed to carbon monoxide gas. Some chemicals or detergents could be harmful if inhaled or ingested, resulting in death, serious injury, nausea, fainting or poisoning.

- Operate this product ONLY outside far away from windows, doors and vents to reduce the risk of carbon monoxide gas from accumulating and potentially being drawn towards occupied spaces.
- Install battery-operated carbon monoxide alarms or plug-in carbon monoxide alarms with battery back-up according to the manufacturer's instructions. Smoke alarms cannot detect carbon monoxide gas.
- DO NOT run this product inside homes, garages, basements, crawlspaces, sheds, or other partially-enclosed spaces even if using fans or opening doors and windows for ventilation. Carbon monoxide can quickly build up in these spaces and can linger for hours, even after this product has shut off.
- ALWAYS place this product downwind and point the engine exhaust away from occupied spaces. If you start to feel sick, dizzy, or weak while using this product, shut it off and get to fresh air RIGHT AWAY. See a doctor. You may have carbon monoxide poisoning.
- Use a respirator or mask whenever there is a chance that vapors may be inhaled when using chemicals.
- Read all instructions with mask so you are certain the mask will provide the necessary protection against inhaling harmful vapors when using chemicals.

WARNING Chemical Burn Hazard.



Chemicals could cause burns resulting in death or serious injury.

- DO NOT use caustic liquid with pressure washer.
- Use ONLY pressure washer safe detergents/soaps. Follow all manufacturers instructions.

WARNING

- Read all the instructions before using the product.
- To reduce the risk of injury, close supervision is necessary when a product is used near children.
- Know how to stop the product and bleed pressures quickly. Be thoroughly familiar with the controls.
- Stay alert – watch what you are doing.
- Do not operate the product when fatigued or under the influence of alcohol or drugs.
- Keep operating area clear of all persons
- Do not overreach or stand on unstable support. Keep good footing and balance at all times.
- Follow the maintenance instructions specified in the manual.

 **WARNING** Starter cord kickback (rapid retraction) will pull hand and arm toward engine faster than you can let go which could cause broken bones, fractures, bruises, or sprains resulting in serious injury.



- NEVER pull starter cord without first relieving spray gun pressure.
- When starting engine, pull cord slowly until resistance is felt and then pull rapidly to avoid kickback.
- After each starting attempt, where engine fails to run, always point spray gun in safe direction, squeeze spray gun trigger to release high pressure.
- Firmly grasp spray gun with both hands when using high pressure spray to avoid injury when spray gun kicks back.

 **WARNING** Risk of electrocution,



Contact with power source could cause electric shock or burn resulting in death or serious injury.

- NEVER spray near power source.

 **WARNING** The high pressure stream of water that this equipment produces could cut through skin and its underlying tissues, resulting in serious injury and possible amputation.



Spray gun traps high water pressure, even when engine is stopped and water is disconnected, which could result in serious injury.

- If cut by fluid, call physician immediately. DO NOT treat as a simple cut.
- DO NOT allow CHILDREN to operate pressure washer.
- NEVER repair high pressure hose. Replace it.
- NEVER repair leaking connections with sealant of any kind. Replace o-ring or seal.
- NEVER connect high pressure hose to nozzle extension.
- Keep high pressure hose connected to pump and spray gun while system is pressurized.
- ALWAYS point spray gun in safe direction, press red button and squeeze spray gun trigger to release high pressure, every time you stop engine.
- NEVER aim spray gun at people, animals, or plants.
- DO NOT secure spray gun in open position.
- DO NOT leave spray gun unattended while machine is running.
- NEVER use a spray gun which does not have a trigger lock or trigger guard in place and in working order.
- Always be certain spray gun, nozzles and accessories are correctly attached.

 **WARNING** Fuel and its vapors are extremely flammable and explosive which could cause burns, fire or explosion resulting in death or serious injury.



WHEN ADDING OR DRAINING FUEL

- Turn pressure washer engine OFF and let it cool at least 2 minutes before removing fuel cap. Loosen cap slowly to relieve pressure in tank.
- Fill or drain fuel tank outdoors.
- DO NOT overfill tank. Allow space for fuel expansion.
- If fuel spills, wipe out redundant fuel before starting engine.
- Keep fuel away from sparks, open flames, pilot lights, heat, and other ignition sources.
- Check fuel lines, tank, cap and fittings frequently for cracks or leaks. Replace if necessary.
- DO NOT light a cigarette or smoke.

WHEN STARTING EQUIPMENT

- Ensure spark plug, muffler, fuel cap, and air cleaner are in place
- DO NOT crank engine with spark plug removed.

WHEN OPERATING EQUIPMENT

- DO NOT operate this product inside any building, carport, porch, mobile equipment, marine applications, or enclosure.
- DO NOT tip engine or equipment at angle which causes fuel to spill.
- DO NOT spray flammable liquids.

WHEN TRANSPORTING, MOVING OR REPAIRING EQUIPMENT

- Transport/move/repair with fuel tank EMPTY or with fuel shutoff valve OFF (0).
- DO NOT tip engine or equipment at angle which causes fuel to spill.
- Disconnect spark plug wire.

WHEN STORING FUEL OR EQUIPMENT WITH FUEL IN TANK

- Store away from furnaces, stoves, water heaters, clothes dryers, or other appliances that have pilot light or other ignition source because they could ignite fuel vapors.

 **WARNING**

- If you do not follow these instructions exactly, a fire or explosion may result causing property damage, personal injury or loss of life.
- In the event of pilot outage, wait at least five minutes to clear out any gas before relighting.
- Use only your hand to push in or turn the gas control knob. Never use a tool. If the knob will not push in or turn by hand, don't try to repair it; call a qualified service technician.

 **WARNING** Exhaust heat/gases could ignite combustibles, structures or damage fuel tank causing a fire, resulting in death or serious injury.

Contact with muffler area could cause burns resulting in serious injury.

- DO NOT touch hot parts and AVOID hot exhaust gases.
- Allow equipment to cool before touching,
- Keep at least 5 ft. (1.5 m) of clearance on all sides of pressure washer including overhead.

It is a violation of California Public Resource Code, Section 4442, to use or operate the engine on any forest covered, brush-covered, or grass-covered land unless the exhaust system is equipped with a spark arrester, as defined in Section 4442, maintained in effective working order. Other states or federal jurisdictions may have similar laws. Contact the original equipment manufacturer, retailer, or dealer to obtain a spark arrester designed for the exhaust system installed on this engine.

- Replacement parts must be the same and installed in the same position as the original parts.

 **WARNING** Use of pressure washer could create puddles and slippery surfaces causing you to fall resulting in death or serious injury.

Kickback from spray gun could cause you to fall resulting in death or serious injury.

- Operate pressure washer from a stable surface.
- The cleaning area should have adequate slopes and drainage to reduce the possibility of a fall due to slippery surfaces.
- Be extremely careful if you must use the pressure washer from a ladder, scaffolding, or any other similar location.
- Firmly grasp spray gun with both hands when using high pressure spray to avoid injury when spray gun kicks back.

 **WARNING** Unintentional sparking could cause fire or electric shock resulting in death or serious injury.

WHEN ADJUSTING OR MAKING REPAIRS TO YOUR PRESSURE WASHER

- Disconnect the spark plug wire from the spark plug and place the wire where it cannot contact spark plug.



WHEN TESTING FOR ENGINE SPARK

- Use approved spark plug tester.
- DO NOT check for spark with spark plug removed.

 **WARNING** Starter and other rotating parts could entangle hands, hair, clothing, or accessories resulting in serious injury.

- NEVER operate pressure washer without protective housing or covers.
- DO NOT wear loose clothing, jewelry or anything that could be caught in the starter or other rotating parts.
- Tie up long hair and remove jewelry.

 **WARNING** Risk of eye or bodily injury.

  Spray could splash back or propel objects resulting in serious injury.

- Always wear indirect vented (chemical splash) safety goggles marked to comply with ANSI Z87.1 when using or in vicinity of this equipment.
- NEVER substitute safety glasses or dry-condition goggles for indirect vented safety goggles.
- Always wear protective clothing such as a long-sleeved shirt, long pants and close-toed shoes.
- NEVER operate pressure washer when barefoot or wearing sandals or shorts.

 **CAUTION** Excessively high operating speeds could result in minor injury.

Excessively low speeds impose a heavy load.

- DO NOT tamper with governor spring, links or other parts to increase engine speed. Pressure washer supplies correct rated pressure and flow when running at governed speed.
- DO NOT modify pressure washer in any way.

NOTICE High pressure spray could damage fragile items including glass.

- DO NOT point spray gun at glass when using red (0 °) spray tip.
- NEVER aim spray gun at plants

NOTICE Improper treatment of pressure washer could damage it and shorten its life.

- If you have questions about intended use, ask dealer or contact qualified service center.
- NEVER operate units with broken or missing parts, or without protective housing or covers.
- DO NOT by-pass any safety device on this machine.
- DO NOT tamper with governed speed.
- DO NOT operate pressure washer above rated pressure.
- DO NOT modify pressure washer in any way.
- Before starting pressure washer in cold weather, check all parts of the equipment to be sure ice has not formed there.
- NEVER move machine by pulling on hoses. Use handle provided on unit.
- Use only identical replacement parts as specified in the Parts List in this manual. User assumes all risks and liabilities if other parts are used.

FEATURES AND CONTROLS

KNOW YOUR PRESSURE WASHER



Read the operator's manual and safety rules before operating your pressure washer.

Compare the illustrations with your pressure washer to familiarize yourself with the locations of various controls and adjustments. Save this manual for future reference.

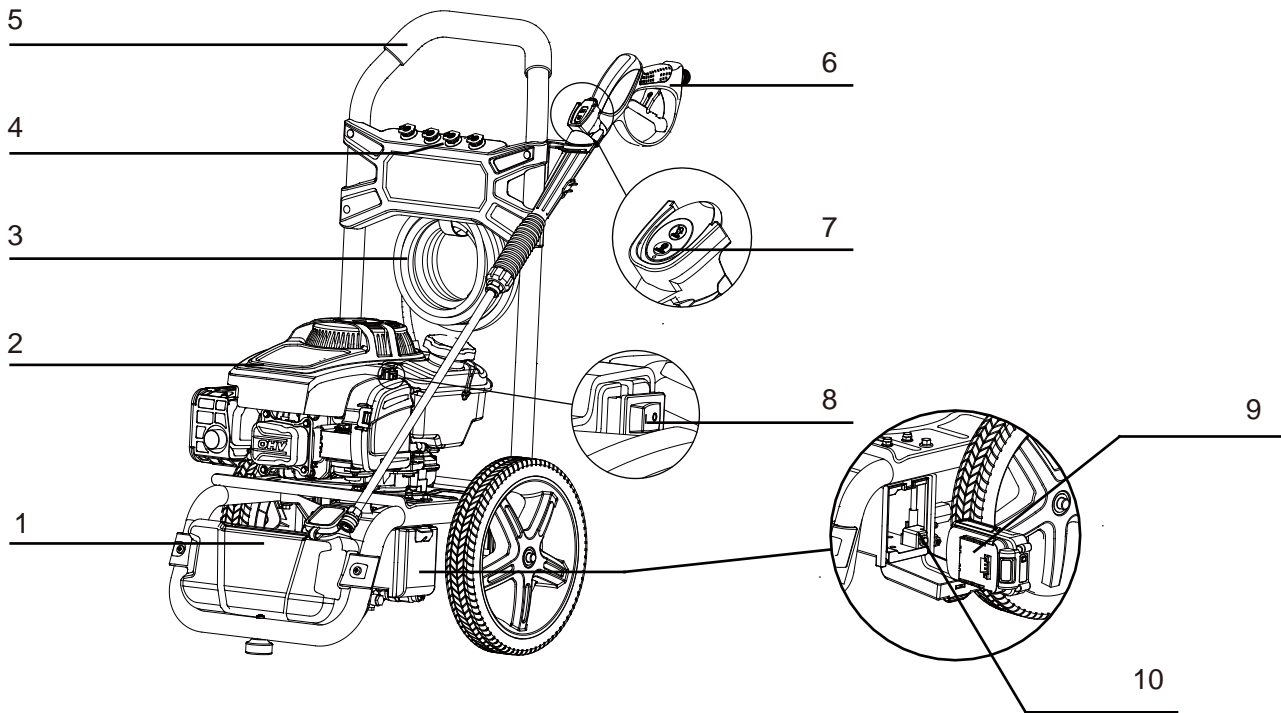

1. Detergent Tank
2. Engine
3. High Pressure Hose
4. Quick-Change Nozzles
5. Upper Handle
6. Spray Gun
7. Remote Control
8. Engine On/Off Switch
9. Li-ion 20V Battery Pack
10. Remote Control connection button
11. Water inlet
12. High Pressure Hose Connection

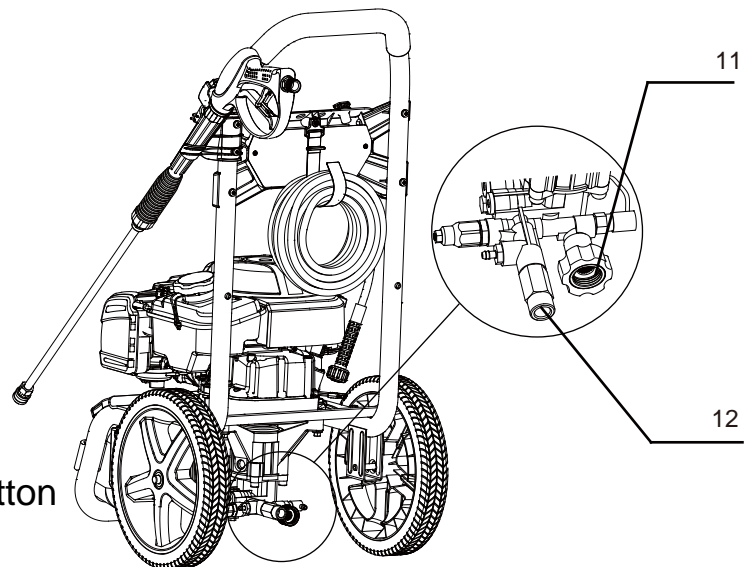

ASSEMBLY

Your pressure washer requires some assembly and is ready for use only after it has been properly serviced with the recommended oil and fuel.

If you have any problems with the assembly of your pressure washer, please call the Yard Force helpline at 1-866-902-9690.

IMPORTANT: Any attempt to run the engine before it has been serviced with the recommended oil will result in an engine failure.

UNPACK THE PRESSURE WASHER

- Remove everything from carton except the pressure washer.
- Open carton completely by cutting each corner from top to bottom.
- Remove pressure washer from carton.

CARTON CONTENTS

Check all contents. If any parts are missing or damaged, call the Yard Force helpline at 1-866-902-9690.

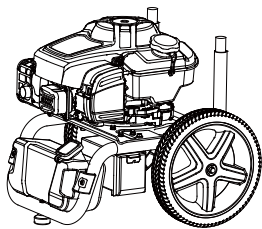

A

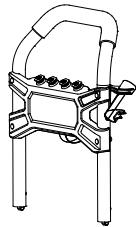

B

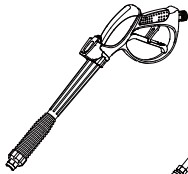

C

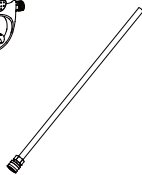

D



E



F



G



H



I



J

- A- Main unit
- B- Upper handle Unit
- C- Spray gun
- D- Spray wand
- E- Li-ion 20V Battery Pack
- F- 20V Battery Charger
- G- High Pressure Hose
- H- Remote Controller
- I- Manual (with needle inside)
- J- Engine oil (SAE 30)

Become familiar with each piece before assembling the pressure washer. Check all contents against the illustration. If any parts are missing or damaged, call the Yard Force helpline at 1-866-902-9690.

ASSEMBLING YOUR PRESSURE WASHER

1. Install the upper handle unit

Install the upper handle like picture shows below, make sure this upper handle snaps into a locked position.

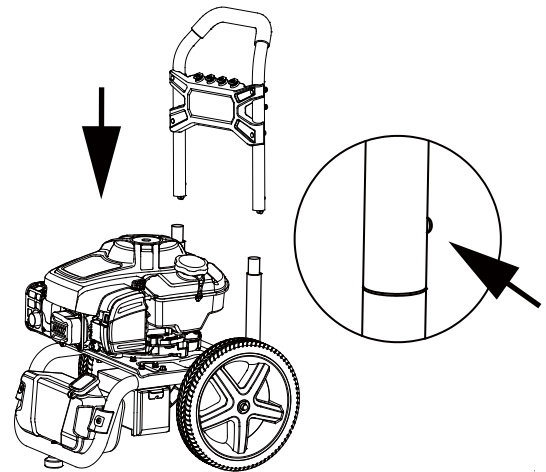

2. Hook the hose onto the hose holder.

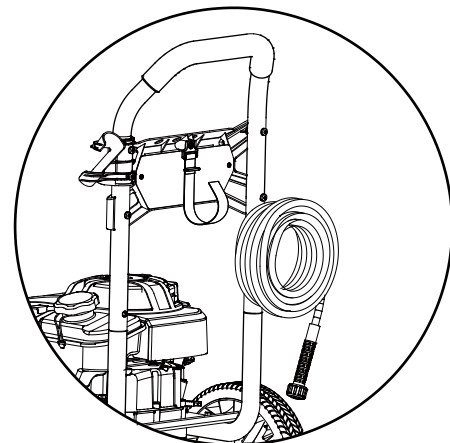

3. Filling with engine oil

IMPORTANT!

The following procedures and adjustments must be performed before the engine is started. Do not attempt to make any of these adjustments while the engine is running.

This engine is shipped without oil or gas, any oil residue is from testing prior to shipping.

The engine must be filled with the correct grade of oil and gas before starting the engine.

Running the engine with a low oil level will cause irreparable engine damage.

Always use high-quality detergent oil classified SAE 30 oil (or equivalent, e.g. 5W 30, often termed as 4-stroke oil).

Only use additives recommended by the engine manufacturer to prolong the life of your engine, it is important that the oil is changed after the first 5 hours of use.

Check the engine oil level with the engine stopped and the pressure washer on a level surface.

1. Remove the oil filler dipstick and wipe oil from it with a clean cloth.
2. Insert the dipstick into the oil filler neck, and screw it in.
3. Then remove the dipstick and check the oil level. The oil level must be between the Min. and Max. marks on the dipstick. If near the lower level, fill to the upper level with the recommended oil (SAE 30 or equivalent). Do not overfill. Wipe away any spilt oil.
4. Before using for the first time, please add engine oil.

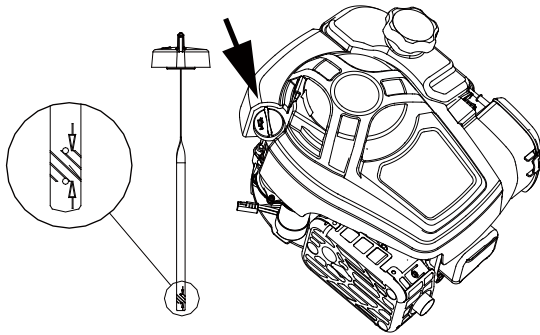

4. Filling with engine fuel

Fuel must meet these requirements:

- Clean, fresh, unleaded gasoline
- A minimum of 87 octane/ 87 AKI (91 RON)
- Gasoline with up to 10% ethanol (gasohol) is acceptable.

WARNING!

Refuel in a well-ventilated area with the engine stopped. Do not smoke or allow flames or sparks in the area where the engine is refueled or where gas is stored. Avoid repeated or prolonged contact with skin or inhalation of vapour.

CAUTION!

Gas is highly flammable and extreme caution must be taken when handling or working with it. Keep out of reach of children.

1. Clean the area around the petrol filler cap before removing the cap. Check the fuel level.
2. Refill the tank if the fuel level is low.
3. Always use clean, fresh unleaded petrol and purchase fuel in quantities that can be used within 30 days.
Never mix oil with gas.
4. To allow for expansion, carefully refuel and avoid overfilling or spillage. There should be no fuel in the filler neck.
5. Clean up any overflow or splashes of gas before starting the engine.
6. Tighten the filler cap after filling, finger tight only.

WARNING! Fuel and its vapors are extremely flammable and explosive which could cause burns, fire or explosion resulting in death or serious injury.

WHEN ADDING FUEL

- Turn pressure washer engine OFF and let it cool at least 2 minutes before removing fuel cap.
- Loosen cap slowly to relieve pressure in tank.
- Fill fuel tank outdoors.
 - **DO NOT** overfill tank. Allow space for fuel expansion.
 - If fuel spills, wait until it evaporates before starting engine.
 - Keep fuel away from sparks, open flames, pilot lights, heat, and other ignition sources.
 - Check fuel lines, tank, cap and fittings frequently for cracks or leaks. Replace if necessary.
 - **DO NOT** light a cigarette or smoke.

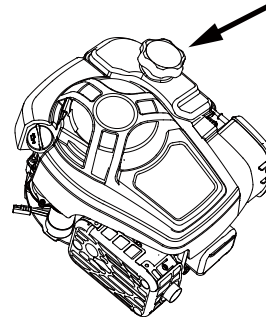

5. Lubricate O-Rings On High Pressure Hose

Lubrication of o-rings is extremely important for installation and operation. The use of lubricant (petroleum or synthetic grease) during assembly helps seat o-rings properly and provides an improved seal. It also helps protect the o-rings from damage by abrasion, pinching or cutting and extends the life of the o-rings.

NOTICE: ALWAYS apply a small amount of lubricant on o-rings prior to assembling the garden hose to the high pressure hose (C), spray gun (D).

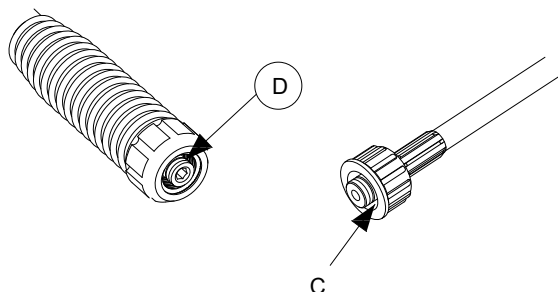

Lubricate all connections shown above, following these instructions:

- 1) Inspect and clean connecting surfaces prior to lubrication and assembly.
- 2) Use lubricants sparingly during assembly; a light film is all that is required.
- 3) Use a small brush or cotton swab to apply grease directly to o-rings where they are not accessible (QC fitting, M22 fitting).

6. Connect Water Supply to Pump

IMPORTANT! DO NOT run the pump without the water supply connected and turned on.

- Damage to pressure washer resulting from failure to follow this instruction will void warranty.

NOTICE: Remove and discard the shipping caps from the pump's high pressure outlet and water inlet before attaching hoses.

Before you connect your garden hose to the water inlet, inspect the inlet screen. Clean the screen if it contains debris or have it replaced if damaged. Do Not run the pressure washer if the inlet screen is damaged or missing.

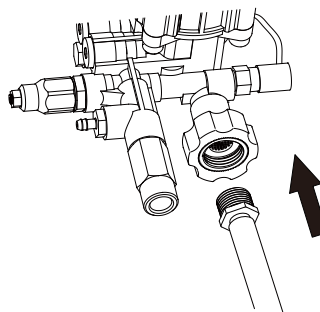

IMPORTANT! NEVER siphon standing water for the water supply. Use only cold water (less than 100 °F).

CAUTION! Using a One Way Valve (vacuum breaker or check valve) at pump inlet could cause pump or inlet connector damage.

- 1) There must be at least 10 ft. (3 m) of unrestricted garden hose between pressure washer inlet and any device, such as a vacuum breaker or check valve.
- 2) Damage to pressure washer resulting from failure to follow this instruction will void warranty.
- 3) Run water through garden hose for 30 seconds to flush it of debris. Turn off water.
- 4) Connect garden hose (not to exceed 50 ft. in length) to water inlet. Tighten by hand.

NOTICE: Water supply must flow at least 3.7 GPM or more.

7. Connect High Pressure Hose to Pump

Take out the high pressure hose from the hose holder, uncoil high pressure hose and attach one end of hose to high pressure outlet on pump. Tighten by hand.

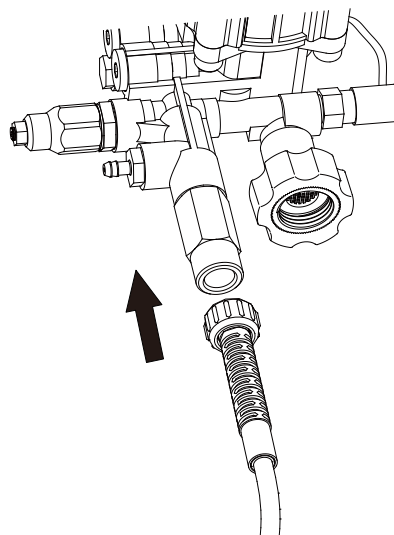

⚠ WARNING! The high pressure stream of water that the pressure washer produces could cut through skin and its underlying tissues, resulting in serious injury and possible amputation.

- **NEVER** connect high pressure hose to spray wand.
- Keep high pressure hose connected to pump and spray gun while system is pressurized.
- Always be certain spray gun, wand, nozzles and other accessories are correctly attached.

8. Connect Spray Wand and Quick-Connect Nozzles

- 1) Attach other end of high pressure hose to base of spray gun. Tighten by hand.

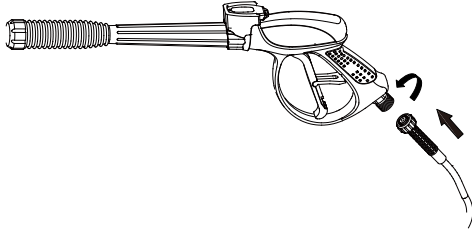

- 2) Attach the spray wand into spray gun. Tighten by hand.

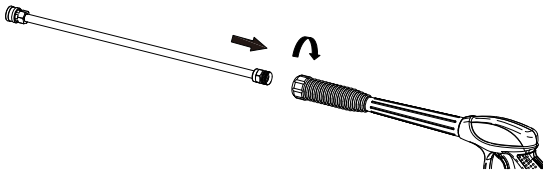

- 3) Turn OFF the water and release trigger. Point the spray gun at a safety direction and make sure trigger is locked and can't be squeezed.
- 4) Choose the quick-connect nozzle you want to use, pull back on collar of spray wand, insert the nozzle and release collar. Tug on the nozzle to make sure it is securely in place. More information please see "How to Use Quick-Connect Nozzles" section.

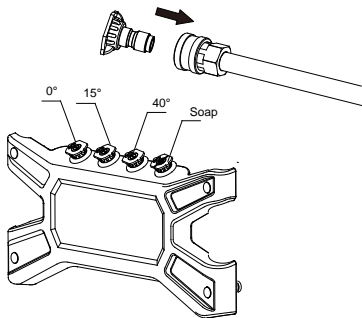

9. Charging the battery

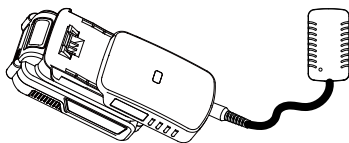

NOTICE:

- The battery pack is supplied partially charged. To ensure the best performance, charge the battery completely before first use.
- Make sure the main voltage is the same as rating label which is located on the charger.
- Remove the battery pack from the charger after it has been fully charged.

1. Connect the charger to a power supply. The red LED light on the charger will be on.
2. To insert the battery pack into the charger, align the grooves on the battery pack with the raised ribs in the opening of the charger.
3. Once the battery pack is correctly located in the charger, the green LED light of the charger will flash continuously during normal charging.
4. When charging is complete, the green LED lights of the charger will be on.

This 20V Li-Ion battery pack is equipped with a power indicator which is used to show the battery pack's remaining charge. Press the power indicator button to check battery charge as below.

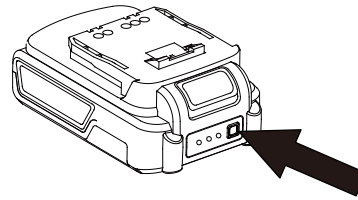

10. Install the battery

Open the battery tank cover, insert battery pack into the tank, make sure it is locked in position, and then close the cover.

NOTICE:

-When the battery pack is well installed, the green breathing light on the remote control button will be illuminated and will begin to flash at a rate of once per second.

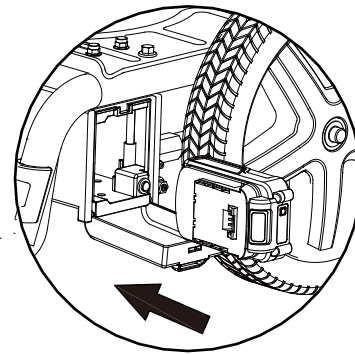

CHECK-LIST BEFORE STARTING ENGINE

Review the assembly to ensure you have performed all of the following:

- Be sure to read "Safety Rules" and "Operation" sections before using the pressure washer.
- Make sure handle is in place and secure.
- Check that oil has been added to proper level in engine crankcase.
- Add proper gasoline to fuel tank.
- Check for properly tightened hose connections (high pressure and water supply) and for tight connections and that there are no kinks, cuts, or damage to the high pressure hose.
- Provide proper water supply (not to exceed 100°F).
- If starting pressure washer after storage, see "Storage" section below.

OPERATION

HOW TO USE YOUR PRESSURE WASHER

If you have any problems operating your pressure washer, please call the Yard Force helpline at **1-866-902-9690**.

Pressure Washer Location

Carbon Monoxide Poisoning

⚠ WARNING! POISONOUS GAS HAZARD.



Engine exhaust contains carbon monoxide, a poisonous gas that could kill you in minutes.

You CANNOT smell it, see it, or taste it. Even if you do not smell exhaust fumes, you could still be exposed to carbon monoxide gas.

- Operate this product ONLY outside far away from windows, doors and vents to reduce the risk of carbon monoxide gas from accumulating and potentially being drawn towards occupied spaces.
- Install battery-operated carbon monoxide alarms or plug-in carbon monoxide alarms with battery back-up according to the manufacturer's instructions. Smoke alarms cannot detect carbon monoxide gas.
- DO NOT run this product inside homes, garages, basements, crawlspaces, sheds, or other partially enclosed spaces even if using fans or opening doors and windows for ventilation. Carbon monoxide can quickly build up in these spaces and can linger for hours, even after this product has shut off.
- ALWAYS place this product downwind and point the engine exhaust away from occupied spaces.

If you start to feel sick, dizzy, or weak while using this product, shut it off and get to fresh air RIGHT AWAY. See a doctor. You may have carbon monoxide poisoning.

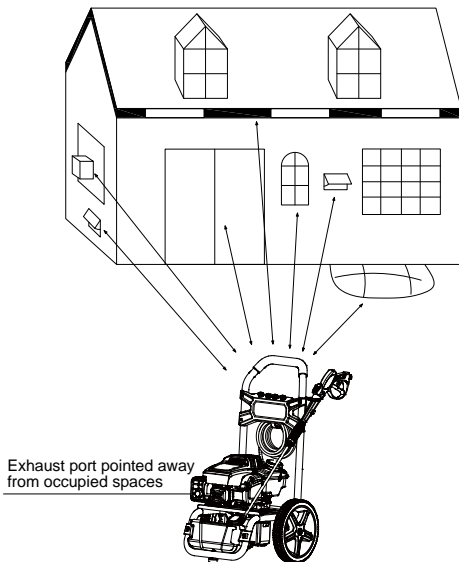

Risk of Fire Clearances

- ⚠ WARNING** Exhaust heat/gases could ignite combustibles, structures or damage fuel tank causing a fire, resulting in death or serious injury.
- Keep at least 5 ft. (1.5 m) clearance on all sides of pressure washer including overhead.

To Start Your Pressure Washer

To start your engine-powered pressure washer for the first time, follow these instructions step-by-step. This starting information also applies whenever you start the engine after you have let the pressure washer sit idle for at least a day.

1. Place pressure washer outside near a water source capable of supplying water at a flow rate greater than 3.7 gallons per minute and no less than 20 PSI at pressure washer end of garden hose.
2. Check that high pressure hose is tightly connected to spray gun and pump.
3. Make sure unit is in a level position.

CAUTION! Do Not run the pump without the water supply connected and turned on.

- Damage to pressure washer resulting from failure to follow this instruction will void warranty.
4. Turn ON the water, point the spray gun at a safe direction, release the trigger lock, then squeeze trigger to purge the pump system of air and impurities.
 5. Choose the quick-connect nozzle you want to use, pull back on collar of spray wand, insert the nozzle and release collar. Tug on the nozzle to make sure it is securely in place.
 6. Engage the trigger lock on the spray gun.
 7. Push engine On/Off to On (I) position.

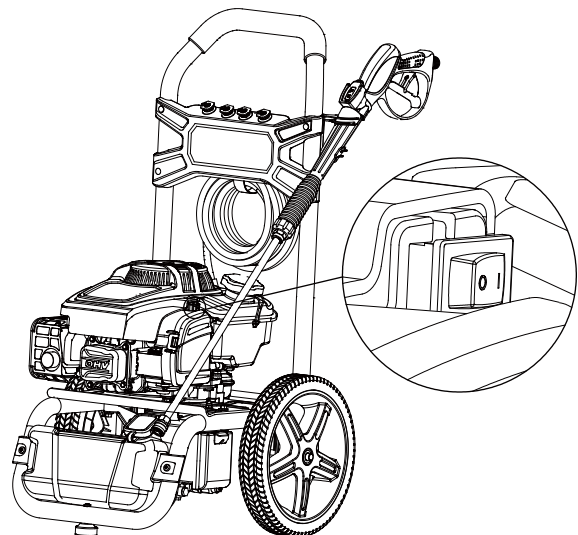

8. Recoil start.

Stand behind the machine, hold the handle firmly with one hand. Pull the starter handle out 10-15cm/4-6" until you feel a resistance and then start the engine with a sharp pull. You can also use remote control to start your pressure washer, see "Remote Control Mode" section.

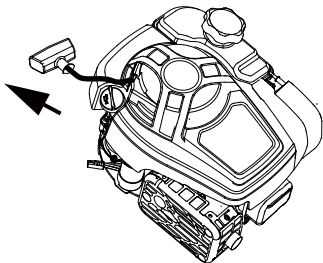

9. Squeeze trigger for more than 5 seconds until there is a steady stream of water.

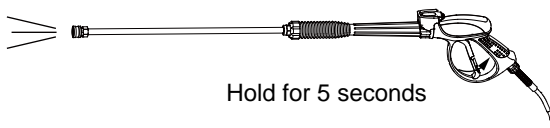

WARNING! Risk of eye injury.



Spray could splash back or propel objects resulting in serious injury.

- Always wear indirect vented (chemical splash) safety goggles marked to comply with ANSI Z87.1 when using or in vicinity of this equipment.
- NEVER substitute safety glasses or dry-condition goggles for indirect vented safety goggles.

How to Stop Your Pressure Washer

1. Release trigger.
2. Push engine On/Off switch to OFF(O) position. Or you can use the remote control to stop the engine see "Remote Control Mode" section.

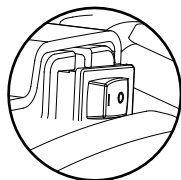

WARNING!

- Every time when you stop engine, ALWAYS point spray gun at safety direction, release the trigger lock, and squeeze spray gun trigger to release high pressure.

NOTICE: A small amount of water will squirt out when you release the pressure.

3. Put the spray gun back to the gun holder.

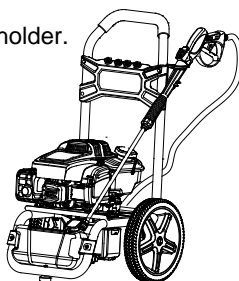

Remote Control Mode

The pressure washer has been matched with the remote control. When using this function for the first time, please make sure that

- The battery pack is well charged and well installed.
- The green breathing light on the battery pack tank flashes at a frequency of once per second.

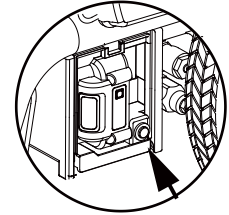

• Make sure the engine On/Off switch is on (I) position. Then you can take out the remote control from the spray gun to start using your remote control function.

1. Press the Start button on the remote control to start the engine.

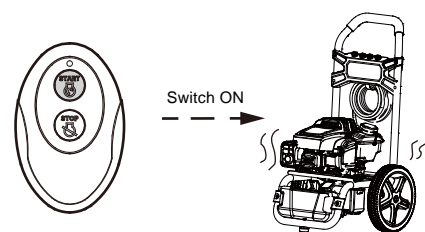

2. Press the STOP button, the engine will be powered off.

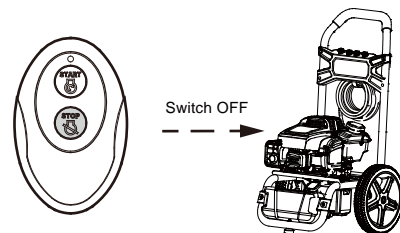

NOTICE:

1. The max control distance is 100 feet without obstacles blocking.
2. With a fully charged battery pack, it can reach almost 100 times starts.

Servo function of the remote control.

When there is no operation for one hour, the remote function will be automatically turned off to save power. To resume the remote control function, you can press the remote control connection button on the breathing light or reinstall the battery pack.

Matching your remote control.

When the remote control function is abnormal, or if the remote control is damaged or lost and replace a new remote control, you need to match the remote control to your pressure washer.

1. Press and hold the remote control connection button on the breathing light for at least 3 seconds and you will see the green light flashes as the frequency of twice per second.

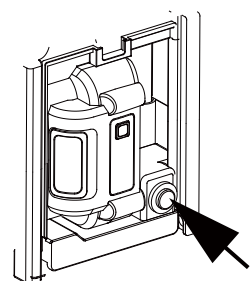

2. Bring the remote control close to remote control connection button, press and hold the stop button on the remote control until the green light flashes as the frequency of once per second. Then the remote function is ready.

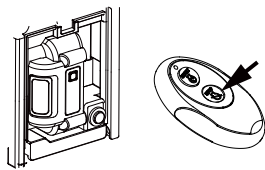

NOTICE:

When pressing the buttons on the remote control, if the red LED is not illuminated, please replace the remote control battery. To replace the battery, please open the back of the remote control, change two old cells with two new batteries. (Battery type: CR2016).

To buy a new remote control, please call the Yard Force helpline at **1-866-902-9690**

• Replacement parts must be the same and installed in the same position as the original parts.

How To Use Quick-Connect Nozzles

The quick-connect on the spray wand allows you to switch between the 4 different quick-connect nozzles included with this pressure washer. Nozzles can be changed while the pressure washer is running once the spray gun trigger is locked. The nozzles vary the spray pattern as shown.

Follow these instructions to change nozzles:

1. Pull back collar on spray wand and pull current nozzle out. Store nozzles in holders on the accessory bracket attached to the handle.

⚠ WARNING The high pressure stream of water that this equipment produces could cut through skin and its underlying tissues, resulting in serious injury and possible amputation.

- NEVER change nozzles without the trigger locked on the spray gun.
- DO NOT twist nozzles while spraying.

2. Select desired nozzle.

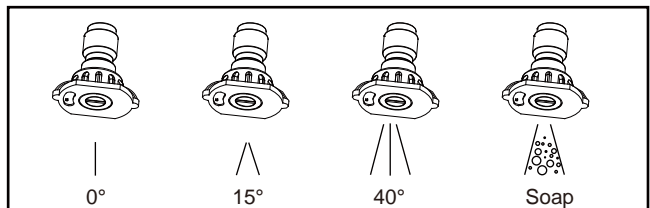

The spray nozzles are in different colors, below are some suggestion for different purposes.

- For general rinsing, ideal for most all purpose cleaning such as home siding, brick patios, wood decks, driveways and sidewalks, garage floors, etc., select yellow 15° nozzle.
- For delicate rinse, for gentle cleaning of cars trucks, boats, RV's, patio furniture, lawn equipment, etc., select white 40° nozzle.
- To apply detergent, applies project specific cleaners to help break down stubborn dirt and grime on a variety of surfaces, select black detergent nozzle.
- For cleaning of hard surfaces like cement, metal, brick, etc. use the 0° nozzle. CAUTION! This nozzle generates a very powerful stream that will damage softer materials including wood, plastic and textile. NEVER use this nozzle to clean any part of any vehicle.

3. Pull back on collar, insert new nozzle and release collar. Tug on nozzle to make sure it is securely in place.

Cleaning Suggestions

- For most effective cleaning, keep nozzle from 8 to 24 inches (20 to 61 cm) away from cleaning surface.
- If you get nozzle too close, especially using a high pressure nozzle, you may damage surface being cleaned.
- Do Not get closer than 6 inches (15 cm) when cleaning tires.

⚠ WARNING! The high pressure stream of water that this pressure washer produces could cut through skin and its underlying tissues, resulting in serious injury and possible amputation.

Spray gun traps high water pressure, even when engine is stopped and water is disconnected, which could result in serious injury.

- DO NOT allow CHILDREN to operate pressure washer.
- Keep high pressure hose connected to pump and spray gun while system is pressurized.
- NEVER aim spray gun at people, animals, or plants.
- DO NOT secure spray gun in open position.
- DO NOT leave spray gun unattended while machine is running.
- NEVER use a spray gun which does not have a trigger lock or trigger guard in place and in working order.
- Always be certain spray gun, nozzles and accessories are correctly attached.

⚠ WARNING! Exhaust heat/gases could ignite combustibles, structures or damage fuel tank causing a fire, resulting in death or serious injury.

Contact with muffler area could cause burns resulting in serious injury.

- DO NOT touch hot parts and AVOID hot exhaust gases.
- Allow equipment to cool before touching.
- Keep at least 5 ft. (1.5 m) of clearance on all sides of pressure washer including overhead.
- It is a violation of California Public Resource Code, Section 4442, to use or operate the engine on any forest covered, brush-covered, or grass-covered land unless the exhaust system is equipped with a spark arrester, as defined in Section 4442, maintained in effective working order. Other states or federal jurisdictions may have similar laws.

Contact the original equipment manufacturer, retailer, or dealer to obtain a spark arrester designed for the exhaust system installed on this engine.

Cleaning and Applying Detergent

To apply detergent, follow these steps:

1. Review "How To Use Quick-Connect Nozzles".
2. Prepare detergent solution as required by the job.
3. The detergent tank is fastened on the frame of the pressure washer. Fill the detergent tank with detergent.

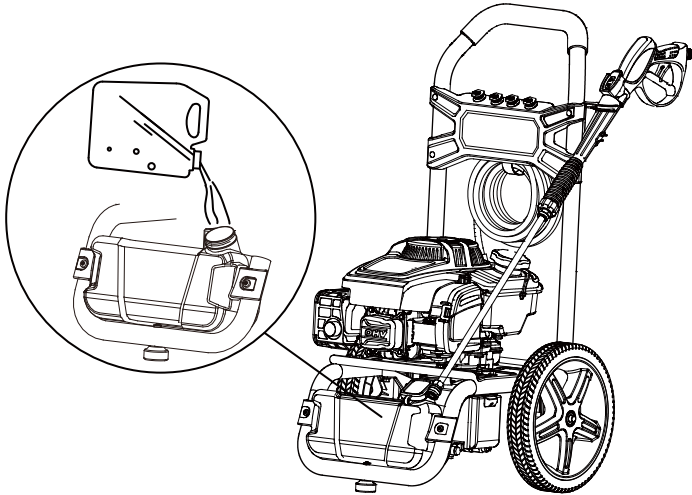

⚠ WARNING! Chemical Burn Hazard.



Chemicals could cause burns resulting in death or serious injury.

- DO NOT use caustic liquid with pressure washer.
- Use ONLY pressure washer safe detergents/soaps.

Follow all manufacturer instructions.

4. Make sure black detergent nozzle is installed.

NOTICE: Detergent cannot be applied with the high pressure nozzles (White, Yellow or Turbo).

5. Make sure the garden hose is connected to the water inlet. Check that the high pressure hose is connected to the spray gun and the pump. Turn on water.

6. Start the engine following instructions "How to Start Your Pressure Washer".

NOTICE: You must attach all hoses before you start the engine

Starting the engine without all the hoses connected and without the water turned on could damage the pump.

- Damage to pressure washer resulting from failure to follow this instruction will void warranty.

7. Apply detergent to a dry surface, starting at lower portion of area to be washed and work upward, using long, even, overlapping strokes.

8. Allow detergent to "soak in" for 3-5 minutes before

washing and rinsing. Reapply as needed to prevent surface from drying. DO NOT allow detergent to dry on (prevents streaking).

Pressure Washer Rinsing

⚠ WARNING! Be extremely careful if you use the



pressure washer from a ladder, scaffolding or any other relatively unstable location. Pressure in a running washer builds as you climb. When you press the trigger, the recoil from the initial spray could cause you to fall. The high pressure spray could also cause you to fall if you are too close to the cleaning surface.

For Rinsing:

1. Remove the black detergent nozzle, and select the nozzles with high pressure following instructions "How To Use Quick-Connect Nozzles", squeeze the spray gun trigger and wait for the detergent to clear.

⚠ WARNING Kickback from spray gun could cause you



to fall resulting in death or serious injury.

- Operate pressure washer from a stable surface.
- Be extremely careful if you must use the pressure washer from a ladder, scaffolding, or any other similar location.
- Firmly grasp spray gun with both hands when using high pressure spray to avoid injury when spray gun kicks back.

2. Keep the spray gun a safe distance from the area you plan to spray.

3. Apply a high pressure spray to a small area, then check the surface for damage. If no damage is found, it is okay to continue cleaning.

4. Start at the top of the area to be rinsed, working down with same overlapping strokes as you used for washing and applying detergent.

SPECIFICATIONS

Pressure Washer Specifications

Max. Outlet Pressure3100 PSI
Max. Flow Rate.....2.4 GPM
Chemical Mix.....Use as directed
Water Supply Temperature.....Not to Exceed 100°F

Engine Specifications

Bore2.73 in. (68.3 mm)
Stroke2.07 in. (51.8 mm)
Displacement11.6 cu. in. (190 cc)
Spark Plug TypeChampion XC92YC / RC12YC
Fuel Capacity1.06 Quarts
Oil CapacityMax. 20 Ounces

Battery pack specification

Battery capacity 20 V d.c., 1.5 Ah

Battery charger specifications

Input 110-120 V 60 Hz
Output 21 V d.c., 0.5 A

NOTICE: For practical operation, the engine load should not exceed 85% of rated power. Engine power will decrease 3.5% for each 1,000 ft. (300 m) above sea level and 1% for each 10° F (5.6 ° C) above 77°F (25 ° C). It should operate satisfactorily at an angle up to 15°.

* This pressure washer is rated in accordance to the Pressure Washer Manufacturers Association (PWMA) standard PW101-2010 (Testing and Rating Performance of Pressure Washers).

MAINTENANCE

OWNER'S RESPONSIBILITIES

Follow the hourly or calendar intervals, whichever occurs first. More frequent service is required when operating in adverse conditions noted below.

Every 8 Hours or Daily
<ul style="list-style-type: none">• Check/clean water inlet screen
<ul style="list-style-type: none">• Check high pressure hose
<ul style="list-style-type: none">• Check detergent siphoning hose
<ul style="list-style-type: none">• Check spray gun and assembly for leaks
<ul style="list-style-type: none">• Clean debris
<ul style="list-style-type: none">• Check engine oil level
Every 50 Hours or Yearly
<ul style="list-style-type: none">• Clean engine air cleaner
<ul style="list-style-type: none">• Inspect muffler and spark arrester
Every 200 Hours or Yearly
<ul style="list-style-type: none">• Replace engine air cleaner
Yearly
<ul style="list-style-type: none">• Replace spark plug
<ul style="list-style-type: none">• Clean cooling system

1. Clean if clogged. Replace if perforated or torn.
2. Service more often under dirty or dusty conditions.

General Recommendations

Regular maintenance will improve the performance and extend the life of the pressure washer. See any Yardforce or other qualified service dealer for service.

The pressure washer warranty does not cover items that have been subjected to operator abuse or negligence. To receive full value from the warranty, the operator must maintain pressure washer as instructed in this manual including proper storage as detailed in "Storage".

Some adjustments will need to be made periodically to properly maintain your pressure washer.

All service and adjustments should be made at least once each season. A new spark plug and clean air filter assure proper fuel-air mixture and help your engine run better and last longer. Follow the requirements in the "Maintenance Schedule" chart above.

NOTICE: Once a year you should clean or replace the spark plug and replace the air filter. A new spark plug and clean air filter assure proper fuel-air mixture and help your engine run better and last longer.

Pump Oil

DO NOT attempt any oil maintenance on this pump.

The pump is pre-lubricated and sealed from the factory, requiring no additional maintenance for the life of the pump.

Emission Control

Maintenance, replacement, or repair of the emissions control devices and systems may be performed by any non-road engine repair establishment or individual.

However, to obtain "no charge" emissions control service, the work must be performed by a factory unauthorized dealer.

Before Each Use

1. Check engine oil level.
2. Clean debris.
3. Check water inlet screen for damage.
4. Check high pressure hose for leaks.
5. Check chemical filters for damage.
6. Check spray gun, spray wand and nozzle assembly for leaks.
7. Purge pump of air and contaminants.

PRESSURE WASHER MAINTENANCE

Clean Debris

Daily or before use, clean accumulated debris from pressure washer. Keep linkage, spring and controls clean. Keep area around and behind muffler free from any combustible debris. Inspect cooling air slots and openings on the pressure washer. These openings must be kept clean and unobstructed.

Pressure washer parts should be kept clean to reduce the risk of overheating and ignition of accumulated debris.

- Use a damp cloth to wipe exterior surfaces clean.

NOTICE: Improper treatment of pressure washer could damage it and shorten its life.

- DO NOT insert any objects through cooling slots.
- Use a soft bristle brush to loosen caked on dirt, oil, etc.
- Use a vacuum cleaner to pick up loose dirt and debris.

Check and Clean Inlet Screen

Examine garden hose inlet screen. Clean if it is clogged or replace if it is torn. Please call help line 1-866-902-9690 for new purchase.

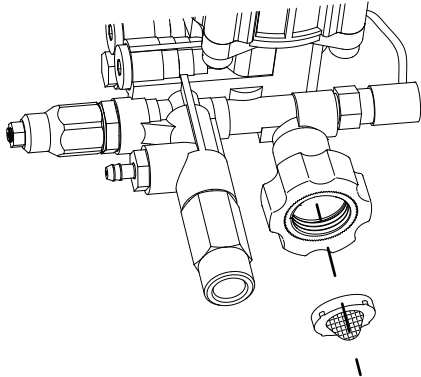

Check High Pressure Hose

High pressure hoses can develop leaks from wear, kinking, or abuse. Inspect hose before each use. Check for cuts, leaks, abrasions, bulging of cover, or damage or movement of couplings. If any of these conditions exist, replace hose immediately. Or call at 1-866-902-9690 for help or new purchase.

⚠ WARNING The high pressure stream of water that this pressure washer produces could cut through skin and its underlying tissues, resulting in serious injury and possible amputation.



- Never repair a high pressure hose. Replace it.
- Replace with hose **MUST** equal or exceed the maximum pressure rating of your pressure washer.

Check Detergent Siphoning Tube

Examine the detergent tube (equipped at the bottom of detergent tank) and clean if clogged. One end of the tube should fit tightly on the tank, the other end fit tightly on the pump. Examine the tube for leaks or tears.

Replace detergent tank or tube if either is damaged. Or call at **1-866-902-9690** for help or new purchase.

Check Spray Gun, Spray Wand and Nozzles

Examine hose connection to spray gun connected with spray wand and make sure it is secure. Test trigger by pressing it and make sure it springs back into place when you release it. Engage trigger lock in UP position and test trigger. You should not be able to squeeze the trigger. Replace spray gun immediately if it fails any of these tests.

Purge Pump of Air and Contaminants

To remove air from the pump, follow these steps:

- Set up the pressure washer as described in the "Assembly" section and connect the water supply.
- Squeeze the trigger on the gun and hold until a steady stream of water appears.

To remove contaminants from the pump, follow these steps:

- Set up the pressure washer as described in the "Assembly" section and connect water supply.
- Remove the nozzle from the spray wand .
- Start the engine according to instructions in "How To Use Your Pressure Washer" section.
- Squeeze the trigger on the gun and hold.
- When the water supply is steady and constant, engage the trigger lock and install the nozzle.

Nozzle Maintenance

A pulsing sensation felt while squeezing the spray gun trigger may be caused by excessive pump pressure. The principal cause of excessive pump pressure is a nozzle clogged or restricted with foreign materials, such as dirt, etc. To correct the problem, immediately clean the nozzle by needle provided with your pressure washer and follow these instructions:

1. Shut off (O) the engine and turn off the water supply.
2. ALWAYS point spray gun at a safety direction, release trigger lock and squeeze spray gun trigger to release retained high water pressure.
3. Remove the nozzle from the end of the spray wand.
4. Use the needle to free any foreign material clogging or restricting the nozzle.

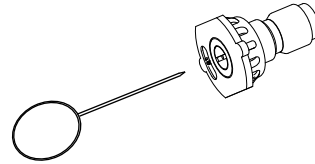

5. Using a garden hose, remove additional debris by back flushing water through the nozzle. Back flush between 30 to 60 seconds.
6. Reinstall the nozzle to the wand with spray gun.
7. Make sure garden hose is connected to water inlet. Check that high pressure hose is connected to spray gun and pump. Turn on water.
8. Start engine following instructions "How to Start Your Pressure Washer".
9. Test pressure washer by operating with each quick-connect nozzle.

O-Ring Maintenance

Through the normal operation of your pressure washer, o-rings keep the connections of the hoses and spray gun tight and leak-free. They may become worn or damaged with use.

You can purchase the replacement o-rings at the pressure washer help line **1-866-902-9690**.

⚠ WARNING The high pressure stream of water that this pressure washer produces could cut through skin and its underlying tissues, resulting in serious injury and possible amputation.

- NEVER repair leaking connections with sealant of any kind. replace o-ring or seal.

ENGINE MAINTENANCE

⚠ WARNING Unintentional sparking could cause fire or electric shock resulting in death or serious injury.

WHEN ADJUSTING OR MAKING REPAIRS TO YOUR PRESSURE WASHER

- Disconnect the spark plug wire from the spark plug and place the wire where it cannot contact spark plug.

WHEN TESTING FOR ENGINE SPARK

- Use approved spark plug tester.
- DO NOT check for spark with spark plug removed.

Oil

Oil Recommendations

We recommend the use of certified oil for best performance. Other high-quality detergent oils are acceptable if classified for service SF, SG, SH, SJ or higher. DO NOT use special additives.

Outdoor temperatures determine the proper oil viscosity for the engine. Use the chart to select the best viscosity for the outdoor temperature range expected.

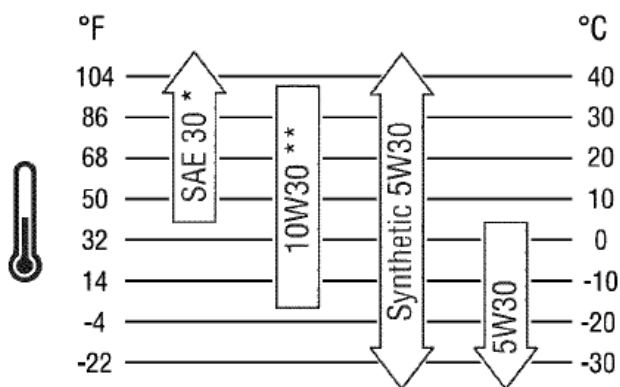

* Below 40°F (4°C) the use of SAE 30 will result in hard starting.

** Above 80°F (27°C) the use of 10W30 may cause increased oil consumption. Check oil level more frequently.

Checking Oil Level.

1. Make sure pressure washer is on a level surface.
2. Remove oil dipstick and wipe dipstick with clean cloth. Replace and tighten dipstick. Remove and check oil level.
3. Verify oil is at FULL mark (top hole) on dipstick. Replace and tighten dipstick.

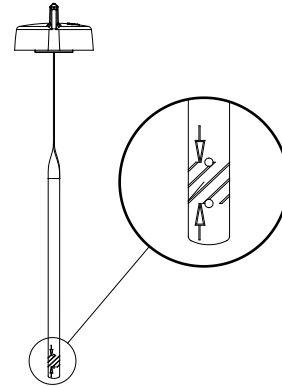

Adding Oil.

1. Make sure pressure washer is on a level surface.
2. Check oil level as described in Checking Off Level.
3. If needed, slowly pour oil into oil fill opening to the FULL mark (top hole) on dipstick. DO NOT overfill.

NOTICE Oil level should be checked prior to each use or at least every 5 hours of operation. Keep oil level maintained.

Overfilling with oil could cause the engine to not start, or hard starting.

- DO NOT overfill.

If over the FULL mark on dipstick, drain oil to reduce oil level to FULL mark on dipstick.

Service Air Cleaner

Your engine will not run properly and may be damaged if you run it with a dirty air cleaner. Service more often if operating under dirty or dusty conditions. Replacements are available at your local Yardfoce service center. Or you can purchase new by calling **1-866-902-9690**.

To service the air cleaner, follow these steps:

⚠️ WARNING!

Never run the engine without the air filter element installed:

1. Loosen the fastener that holds the cover.
2. Open the cover and remove the filter.
3. To loosen debris, gently tap the filter on a hard surface. If the filter is excessively dirty, replace with a new filter.
4. Install the filter.
5. Install the cover tabs into the slots.
6. Close the cover and secure with the fastener.

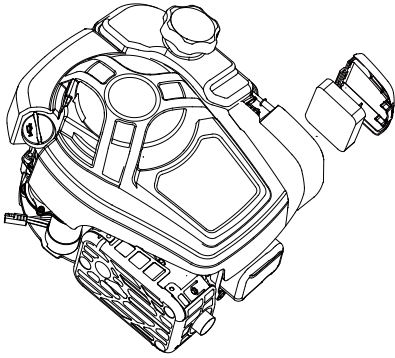

Service Spark Plug

Changing the spark plug will help your engine to start easier and run better. Disconnect spark plug wire from spark plug and keep wire away from spark plug while servicing engine.

1. Clean area around spark plug.
2. Remove and inspect spark plug.
3. Replace spark plug if electrodes are pitted, burned or porcelain is cracked.
4. For replacement use the standard resistor spark plug.
5. Check electrode gap with wire feeler gauge and set gap at 0.432-0.584 mm, if necessary.
6. Install spark plug, tighten securely.

NOTE: You can purchase a new spark plug by calling **1-866-902-9690**.

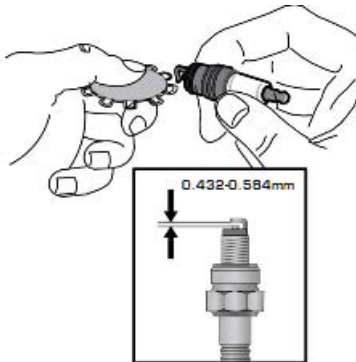

Inspect Muffler and Spark Arrester

Inspect the muffler for cracks, corrosion, or other damage. Remove the spark arrester if equipped, and inspect for damage or carbon blockage. If replacement parts are required, make sure to use only original equipment replacement parts.

NOTICE: You can purchase a spark arrester by calling **1-866-902-9690**.

⚠️ **WARNING!** Exhaust heat/gases could ignite combustibles, structures or damage fuel tank causing a fire, resulting in death or serious injury.



Contact with muffler area could cause burns resulting in serious injury.

- DO NOT touch hot parts and AVOID hot exhaust gases.
- Allow equipment to cool before touching.
- Keep at least 5 ft. (1.5 m) of clearance on all sides of pressure washer including overhead.
- It is a violation of California Public Resource Code, Section 4442, to use or operate the engine on any forest covered, brush-covered, or grass-covered land unless the exhaust system is equipped with a spark arrester, as defined in Section 4442, maintained in effective working order. Other states or federal jurisdictions may have similar laws.

Contact the original equipment manufacturer, retailer, or dealer to obtain a spark arrester designed for the exhaust system installed on this engine.

- Replacement parts must be the same and installed in the same position as the original parts.

Air Cooling System

Over time debris may accumulate in cylinder cooling fins and cannot be observed without partial engine disassembly. For this reason, we recommend you have a qualified Yardfoce service dealer clean the cooling system per recommended intervals (see Maintenance Schedule). Equally important is to keep top of engine free from debris. See "Clean Debris".

Carburetor Adjustment

The carburetor on this engine is low emission. It is equipped with a non-adjustable idle mixture valve. Top speed has been set at the factory. If adjustment is required, see an authorized service dealer.

CAUTION! Excessively high operating speeds could result in minor injury.

Excessively low speeds impose a heavy load.

- DO NOT tamper with governor spring, links or other parts to increase engine speed. Pressure washer supplies correct rated pressure and flow when running at governed speed.
- DO NOT modify pressure washer in any way.

After Each Use

Water should not remain in pressure washer for long periods of time. Sediments or minerals can deposit on pump parts and "freeze" pump action. Follow these procedures after every use:

1. Shut OFF engine, turn off water supply, point gun at a safety direction, release trigger lock and squeeze trigger of spray gun to relieve trapped pressure and let engine cool.

WARNING! The high pressure stream of water that pressure washer produces could cut through skin and its underlying tissues, resulting in serious injury and possible amputation.

Spray gun traps high water pressure, even when engine is stopped and water is disconnected, which could result in serious injury.

Keep high pressure hose connected to pump and spray gun while system is pressurized.

ALWAYS point spray gun in safe direction, release trigger lock and squeeze trigger of spray gun p to release high pressure, every time you stop engine.

2. Disconnect hose from spray gun. Drain water from hose, gun, and wand.
3. Empty pump of all pumped liquids.
4. Store the spray gun, wand, nozzles
5. Store the pressure washer in a clean, dry area.
6. If storing for more than 30 days see "Long Term Storage" on next page.

WARNING! Fuel and its vapors are extremely flammable and explosive which could cause burns, fire or explosion resulting in death or serious injury.



WHEN STORING FUEL OR EQUIPMENT WITH FUEL IN TANK

- Store away from furnaces, stoves, water heaters, clothes dryers, or other appliances that have pilot light or other ignition source because they could ignite fuel vapors.

Remote Control indicator meaning

Green light flashing (2Hz during matching)	Matching model
Green light flashing (2.5Hz when normal operating)	Overcurrent, restart the machine
	Battery pack lack of power, charge the battery
	Battery pack overheat, let it cool for a while, and then try again.

NOTICE:

When pressing the buttons on the remote control, if the red LED is not illuminated, please replace the remote control battery. To replace the battery, please open the back of the remote control, change two old cells with two new batteries. (Battery type: CR2016)

To buy a new remote control, please call the Yard Force helpline at **1-866-902-9690**.

STORAGE

WINTER STORAGE

CAUTION You must protect your pressure washer from freezing temperatures.

- Failure to do so will permanently damage your pump and render your unit inoperable.
- Freeze damage is not covered under warranty.

To protect the pressure washer from freezing temperatures:

1. Follow steps 1-6 in the previous section "After Each USE".
2. Use pump saver, to treat pump. This prevents freeze damage and lubricates pistons and seals.
3. If pump saver is not available, connect a 3-foot section of garden hose to the water inlet adapter. Pour RV-antifreeze (antifreeze without alcohol) into the hose. Pull the recoil handle twice. Disconnect 3-foot hose.
4. Store the pressure washer in a clean, dry area.

LONG TERM STORAGE

If you do not plan to use the pressure washer for more than 30 days, you must prepare the engine and pump for long term storage.

It is important to prevent gum deposits from forming in essential fuel system parts such as the carburetor, fuel filter, fuel hose or tank during storage. Also, experience indicates that alcohol-blended fuels (called gasohol, ethanol or methanol) can attract moisture, which leads to separation and formation of acids during storage. Acidic gas can damage the fuel system of an engine while in storage.

Protect Fuel System

Fuel Additive:

Fuel can become stale when stored over 30 days. Stale fuel causes acid and gum deposits to form in the fuel system or on essential carburetor parts. To keep fuel fresh, we recommend use the fuel additive supplied by a qualified Yardforce service dealer.

There is no need to drain gasoline from the engine if a fuel stabilizer is added according to instructions. Run the engine for 2 minutes to circulate the stabilizer throughout the fuel system before storage.

If gasoline in the engine has not been treated with a fuel stabilizer, it must be drained into an approved container. Run the engine until it stops from lack of fuel.

The use of a fuel stabilizer in the storage container is recommended to maintain freshness.

Change Oil

While engine is still warm, drain oil from crankcase. Refill with recommended grade. See "Changing Oil" section.

Oil Cylinder Bore

1. Remove spark plug. Squirt about 1 tablespoon of clean engine oil into the cylinder. Cover spark plug hole with rag. Pull recoil handle slowly to distribute oil. Avoid spray from spark plug hole.
2. Install spark plug. Do Not connect spark plug wire.

Protect Pump

To protect the pump from damage caused by mineral deposits or freezing, use Pump Saver, to treat pump. This prevents freeze damage and lubricates pistons and seals.

NOTE Pump Saver is available as an optional accessory. It is not included with the pressure washer.

Contact your local Yardforce service center to purchase Pump Saver.

CAUTION You must protect your unit from freezing temperatures.

- Failure to do so will permanently damage your pump and render your unit inoperable.
- Freeze damage is not covered under warranty.

To use the Pump Saver:

CAUTION Read and follow all cautions and warnings on the pump saver can label. Always wear eye protection when using pump saver.

1. Remove the hose connector from the pump outlet.
2. Attach hose on pump saver can to pump inlet.
3. Push in can top to dispense pump saver.
4. When pump saver fluid begins to exit pump outlet, the pump is protected.
5. Remove pump saver from pump inlet.

Other Storage Tips

1. DO NOT store fuel from one season to another unless it has been treated as described in Protect Fuel System.
2. Replace fuel container if it starts to rust. Rust and/ or dirt in fuel can cause problems if it's used with this pressure washer.
3. Cover unit with a suitable protective cover that does not retain moisture.



WARNING Storage covers could cause a fire resulting in death or serious injury.

- DO NOT place a storage cover over a hot pressure washer.
- Let equipment cool for a sufficient time before placing the cover on the equipment.

4. Store pressure washer in a clean and dry area.

TROUBLESHOOTING

Problem	Cause	Correction
Pump has following problems. No pressure, low pressure	1.Nozzle tip not attached.	1. Attached required nozzle tip
	2. Water inlet is blocked.	2. Clear inlet.
	3. Inadequate water supply.	3. Provide adequate water flow.
	4. Inlet hose is kinked or leaking.	4. Straighten inlet hose, patch leak.
	5. Clogged inlet hose strainer	5. Check and clean inlet hose strainer.
	6. Water supply is over 100°F.	6. Provide cooler water supply.
	7. High pressure hose is blocked or leaks.	7. Clear blocks in outlet hose.
	8. The loaded RPM is not set to HIGH	8. Set RPM (Throttle lever) to HIGH position.
	9. Nozzle is obstructed.	9. Clean nozzle.
	10. Damaged pump.	10. Contact Yardforce service facility.
No intake of detergent.	1. Detergent siphoning tube is not connected.	1. Connect detergent siphon tube Properly.
	2. Chemical filter is clogged.	2. Clean or replace filter/detergent siphoning tube.
	3. Dirty in-line filter.	3. See "Check In-Line Filter" on page 10.
	4. Wrong nozzle.	4. Use black nozzle when applying detergent. Refer to the instruction manual.
	5. Damaged detergent siphoning tube.	5. Replace detergent siphoning tube.
Engine sounds abnormal or overloaded	1. Pressure is too high	1. Contact Yardforce service facility.
Engine doesn't start	1. The engine power switch is OFF(O) position.	1. Ensure the switch is in ON (I) position
	2. No fuel.	2. Fill the fuel tank with regular gasoline.
	3. Dirty air cleaner.	3. Clean or replace air cleaner.
	4. Stale gasoline.	4. Drain gas tank; fill with fresh fuel.
	5. Spark plug wire not connected to spark plug.	5. Connect wire to spark plug.
	6. Bad spark plug.	6. Replace spark plug.
	7. Low oil level.	7. Fill crankcase to proper level.
	8. Clogged carburetor.	8. Clean the carburetor.
	9. Excess water pressure in pump or hose.	9. Release water pressure by squeezing trigger on gun.
	10. Engine has lost compression.	10. Contact Yardforce service facility.
Remote controller does not work	1.Controller was not matched to engine successfully	1. Re-match the device and then try again
	2.Battery low	2. Charging the battery
	3.controller Battery low	3. Replace a new controller Battery
Engine stops down during operation.	Out of gasoline.	Fill fuel tank.
Engine lacks power.	Dirty air filter.	Replace air filter.
Starter rope doesn't recoil	Recoil mechanism is broken.	Contact Yardforce service facility.

WARRANTY

YARDFORCE TWO YEAR LIMITED WARRANTY

Product Warranty

Please keep your original purchase receipt in a safe place as proof of purchase. Warranty coverage for this product must be verified by the original purchase receipt. The warranty period begins on the day that the product was purchased from an authorized retailer of Yard Force products. Warranty coverage only applies to the original purchaser and is not transferrable. Warranty coverage is only provided on products purchased and used in the USA from authorized Yard Force retailers. Products purchased or used outside of the USA are not covered by this warranty.

(2) Two-Year Warranty – Pump and Engine

The Y0GWB31EW00 has a 2-Year Limited Warranty from the date of purchase against manufacturer defects for residential use only. Commercial use voids the warranty. This warranty does not cover accidental damage, unreasonable use, normal wear and tear, neglect or non-compliance with the Operating, Safety and Maintenance Instructions. All service, outside of normal maintenance as described in this manual, must be done by an authorized service technician. Any unauthorized service or changes to the original configuration of this product will void the warranty. All parts and accessories used on and with this product must be manufacturer/or and authorized by Merotec Inc.

(90) Ninety-Day Warranty – Accessories

The accessories included with the Y0GWB31EW00; including hose, trigger handle and wand, and other similar parts are warranted against manufacturer defects for residential use only for a period of 90 days from date of purchase.

Warranty does not cover loss of use or other consequential damages arising from any of the above, nor does it cover repairs made or attempted by unauthorized persons. This warranty is void if the product is used for commercial, rental or industrial purposes. Certain parts, attachments and accessories are subject to normal wear and tear and are excluded from the warranty.

Service and Warranty Claims Process

Contact the Yard Force Support Center toll-free at **(866) 902-9690 Monday-Friday between 8:30 AM and 5:00 PM Eastern Time** for service and warranty support.

Yard Force USA Service Support agents can help you troubleshoot problems over the phone to get you back up and running as quickly as possible. In the situation where service or warranty inspection is needed, please follow these steps:

1. Contact Yard Force USA at **(866) 902-9690 Monday-Friday between 8:30 AM and 5:00 PM Eastern Time**.
2. Send in proof-of-purchase and serial number (if applicable) to confirm warranty coverage.
3. If service or a warranty evaluation is requested, Yard Force USA will provide an RGA number that should be used in all communications with Yard Force USA and is required to be indicated on the product itself and on the outside of the box.
4. All shipments to Yard Force USA must have an RGA number. Any shipment received that does not have an RGA number clearly marked on the outside of the box will be refused.
5. All shipments must be sent pre-paid, Yard Force USA does not pay for any shipping costs for service or warranty evaluation. Yard Force USA is not responsible for any packages that are lost by carrier. We recommend that shipments are made by a carrier that provides tracking and delivery confirmation.

For more information or to ask questions, please call toll-free **(866) 902-9690 Monday-Friday between 8:30 AM and 5:00 PM Eastern Time**.

SAVE THESE INSTRUCTIONS



YARD FORCE[®]
OUTDOOR POWER EQUIPMENT

Need Help?

Please do not return the product to the place of purchase yet. We're here to help and take care of all your needs.

Contact our customer service department for help with:

- Product assembly or use
- Missing or damaged parts
- Troubleshooting

You can also visit our website for typical FAQ's, downloadable troubleshooting steps and instructional videos. Replacement parts and accessories can be purchased at www.YardForceUSA.com, or call our toll free hotline: 1-866-902-9690 M-F 8:30am – 5:00pm ET



1-866-902-9690



www.YardForceUSA.com

¿Necesita ayuda?

Por favor, todavía no devuelva el producto al lugar donde lo compró. Estamos aquí para ayudarle y atender todas sus necesidades.

Póngase en contacto con el departamento de servicio al cliente para ayuda con:

- Montaje o uso del producto
- Piezas faltantes o dañadas
- Resolución de problemas

También puede visitar nuestro sitio web para ver las preguntas frecuentes, los pasos de resolución de problemas descarga abrir y vídeos tutoriales. Las piezas de recambio y los accesorios se pueden comprar en www.YardForceUSA.com, o llame sin costo a nuestra línea gratuita: 1-866-902-9690 L-V 8:30am - 5:00pm ET

Merotec Inc.

3655 Kennesaw North Industrial Parkway Kennesaw, GA 30144
Copyright © 2020 Merotec Inc.

Hecho en China en instalaciones manufactureras de SUMEC