



YARD FORCE[®]

OUTDOOR POWER EQUIPMENT

YF120vRX24-SB

YF120vRX24-SB 24" DUAL-STAGE CORDLESS SNOW BLOWER OWNER'S MANUAL

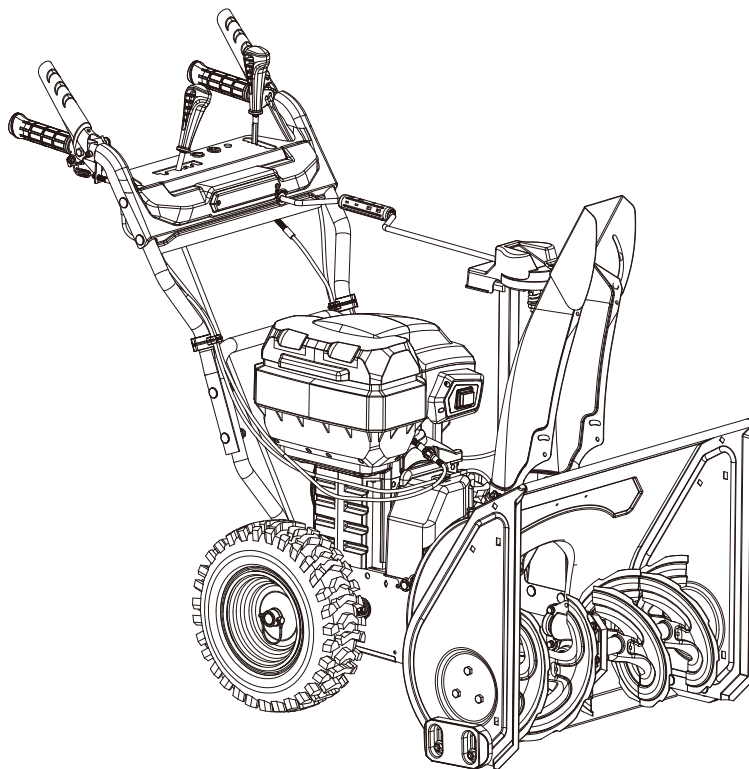

Our Customer Service staff is ready to provide assistance.

In the case of a damaged or missing part, most replacement parts ship from our facility.

For immediate help with assembly, or for additional product information, email support@MerotecUSA.com or call 866-902-9690 M-F 8:30am – 5:00pm ET. More information can be found on www.YardForceUSA.com.



SAVE THIS MANUAL FOR REFERENCE



You will need this manual for safety instructions, operating procedures, and Warranty. The original sales receipt is required for warranty service.

YARD FORCE

YF120vRX24-SB Original Instructions

TABLE OF CONTENTS

Safety Instructions.....	3
Description of Symbols.....	7
Parts List.....	8
Technical Specifications.....	11
Assembly.....	12
Operation.....	15
Maintenance and Storage.....	24
Troubleshooting.....	28
Warranty.....	30

SAFETY INSTRUCTIONS



WARNING!

To reduce the risk of injury, the user must read and understand the owner's manual before using this product.



WARNING!

READ AND UNDERSTAND ALL INSTRUCTIONS. Failure to follow all instructions listed below and on the machine could result in electric shock, fire, serious personal injury and/or death.



DANGER:

This snow blower is capable of amputating hands and feet and throwing objects. Failure to observe the following safety instructions could result in serious injury.

FOR ALL SNOW BLOWERS

- Do not use on graveled surface unless the snow blower is adjusted for such a surface in accordance with the operator's manual.
- Keep Children Away – All visitors should be kept a safe distance from work area.
- Dress Properly – Do not wear loose clothing or jewelry. They can be caught in moving parts.
- Wear rubber boots when operating the snow blower.
- Keep hands away from moving parts.
- Keep guards in place and in working order.
- Don't Force Snow Blower – It will perform better and safer at the rate for which it was designed.
- Don't Overreach – Keep proper footing and balance at all times
- If the snow blower strikes a foreign object follow these steps:
 - 1) Stop snow blower. Set the on/off switch to the "off" position.
 - 2) Remove the battery pack(s).
 - 3) Inspect for damage.
 - 4) Repair any damage before restarting and operating the snow blower.
- Store Idle Snow Blowers Indoors-When not in use, snow blowers should be stored indoors in dry, locked-up place – out of reach of children.
- Maintain Snow Blowers with Care – Following instructions for lubricating and changing accessories.

TRAINING

- Read, understand and follow all instructions on the machine and in the manual(s) before operating this unit. Be thoroughly familiar with the controls and the proper use of the equipment. Know how to stop the unit and disengage the controls quickly.
- Never allow children to operate the equipment. Never allow adults to operate the equipment without proper instruction.
- Keep the area of operation clear of all persons, particularly small children.
- Exercise caution to avoid slipping or falling, especially when operating the snow blower in reverse.

PREPARATION

- Thoroughly inspect the area where the equipment is to be used and remove all doormats,

SAFETY INSTRUCTIONS

sleds, boards, wires, and other foreign objects.

- Do not operate the equipment without wearing adequate winter garments. Avoid loose-fitting clothing that can get caught in moving parts. Wear footwear that will improve footing on slippery surfaces.
- Never attempt to make any adjustments while the motor is running (except when specifically recommended by manufacturer).
- Always wear safety glasses or eye shields during operation or while performing an adjustment or repair to protect eyes from foreign objects that may be thrown from the machine.

OPERATION

- Prevent unintentional starting. Ensure the switch is in the off-position before connecting to battery pack, picking up or moving the product. Moving the product with your finger on the switch or energizing tools that have the switch on invites accidents.
- Do not put hands or feet near or under rotating parts. Keep clear of the discharger opening at all times.
- Exercise extreme caution when operating on or crossing gravel, driveways, sidewalks, or roads. Stay alert for hidden hazards or traffic.
- After striking a foreign object, stop the motor. Remove the battery pack(s), thoroughly inspect the snow blower for any damage, and repair the damage before restarting and operating the snow blower.
- If the unit should start to vibrate abnormally, stop the motor and check immediately for the cause. Vibration is generally a warning of trouble.
- Stop the motor whenever you leave the operating position, before unclogging the auger assembly housing or discharge chute, and when making any repairs, adjustments or inspections.
- When clearing, repairing or inspecting the snow blower, stop the motor and make certain the auger assembly and all moving parts have stopped. Remove the battery pack(s) or safety key to prevent someone from accidentally starting the motor.
- Exercise extreme caution when operating on slopes.
- Never operate the snow blower without proper guards and other safety protective devices in place and working.
- Never direct the discharge toward people or areas where property damage can occur. Keep children and others away.
- Do not overload the machine capacity by attempting to clear snow at too fast a rate.
- Disengage power to the auger assembly when snow blower is transported or not in use.
- Use only attachments and accessories approved by the manufacturer of the snow blower remove text.
- Never operate the snow blower without good visibility or light. Always be sure of your footing, and keep a firm hold on the handles. Walk; never run.
- Do not expose a battery pack or tool to fire or excessive temperature. Exposure to fire or temperature above 212 °F (100°C) may cause explosion.
- Use only with the battery pack Y0L120BAT2.5 and charger Y0L120CGR.

CLEARING A CLOGGED DISCHARGE CHUTE

Hand contact with the rotating auger assembly inside the discharge chute is the most common cause of injury associated with snow blowers. Never use your hand to clean out the discharge chute.

SAFETY INSTRUCTIONS

To clear the chute:

- SHUT THE MOTOR OFF!
- Remove the battery pack(s) from the snow blower.
- Wait 10 seconds to be sure the auger has stopping rotating.
- Always use the chute clean-out tool which is attached to the machine as an accessory, do not use your hand.

MAINTENANCE AND STORAGE

- Check all bolts or fasteners at frequent intervals for proper tightness to be sure the equipment is in safe working condition.
- Always refer to operator's manual for important details if the snow blower is to be stored for an extended period.
- Maintain or replace safety and instruction labels, as necessary.
- Run the machine a few minutes after blowing snow to prevent freeze-up of the auger assembly.
- SAVE THESE INSTRUCTIONS. Refer to them frequently and use them to instruct others who may use this tool. If you lend this tool to someone else, also lend these instructions to them to prevent misuse of the product and possibly injury.

ADDITIONAL SAFETY RULES FOR BATTERIES

- Do not open or mutilate the batteries. Released electrolyte is corrosive and may cause damage to the eyes or skin. It may be toxic if swallowed.
- Do not dispose of the batteries in a fire. The batteries could explode. Check with your local waste authority for information regarding available recycling and/ or disposal options. When batteries are not in use, keep away from other metal objects like paper clips, coins, keys, nails, screws, or other small metal objects that can make a connection from one terminal to another. Shorting the battery terminals together may cause serious burns or a fire.
- Exercise care in handling batteries in order not to short the battery with conducting materials such as rings, bracelets, and keys. The battery or conductor may overheat and cause burns.
- Under extreme usage or temperature conditions, battery leakage may occur. If liquid comes in contact with your skin, wash immediately with soap and water. If liquid gets into your eyes, flush them with clean water for at least 10 minutes, then seek immediate medical attention. Following this rule will reduce the risk of serious personal injury.
- Do not charge battery in an area of extreme heat or cold. Batteries will charge best at temperatures from 32°F to 104°F.
- Only use YARD FORCE Y0L120BAT2.5 120V Li-ion battery pack.

SAFETY RULES FOR CHARGER

1. SAVE THESE INSTRUCTIONS - DANGER - TO REDUCE RISK OF FIRE OR ELECTRIC SHOCK, CAREFULLY FOLLOW THESE INSTRUCTIONS. This manual contains important safety and operating instructions for battery charger Y0L120CGR.
2. Before using battery charger, read all instructions and cautionary markings on battery charger, battery, and product using battery.
3. To reduce the risk of injury, charge only YARD FORCE Y0L120BAT2.5 120V Li-ion battery pack using Y0L120CGR.
4. TO REDUCE THE RISK OF FIRE, ELECTRIC SHOCK, DEATH, OR SERIOUS PERSONAL INJURY, CAREFULLY FOLLOW THESE INSTRUCTIONS.

SAFETY INSTRUCTIONS

- This manual contains important safety and operating instructions for the charger. Refer to them frequently and use them to instruct others who may use this product. If you loan someone this product, loan them these instructions also to prevent misuse of the product and possible injury.
- Before using the charger, read and understand all instructions and cautionary markings in this manual, on battery charger, batteries, and 120V snow blower to prevent misuse of the products and possible injury or damage.
- The charger is not meant for use by children.
- Provide adequate ventilation for the charger to dissipate heat during charging. The charger will get hot. Keep away from flammable and combustible material and do not cover the charger.
- Risk of Burn Hazard — Charger surfaces may be hot during operation. Use the charger handle only. Mount charger on a table or wall with the cooling fins vertical.
- Risk of electric shock. Do not touch uninsulated portion of output connector or uninsulated battery terminal.
- Do not use charger outdoors or expose to wet or damp conditions. Water entering charger will increase the risk of electric shock. The charger must be plugged into a Class A GFCI receptacle when used outdoors.
- Keep charger and charger plug free of contamination and dirt. Do not let gasoline, oils, petroleum-based products, etc. come in contact with plastic parts. They contain chemicals that can damage, weaken, or destroy plastic.
- Keep cord and charger away from heat to prevent damage to housing or internal parts.
- Do not operate charger with a damaged cord or plug, which could cause shorting and electric shock. If damaged, have the charger replaced by an authorized service person.
- Do not operate charger if it has received a sharp blow, been dropped, or otherwise damaged in any way. Take it to an authorized service person for electrical check to determine if the charger is in good working order.
- Make sure cords are located so that they will not be stepped on, tripped over, come in contact with sharp edges or moving parts, or otherwise subjected to damage or stress. This will reduce the risk of accidental falls, which could cause injury, and damage to the cords, which could result in electric shock.
- An extension cord should not be used unless absolutely necessary. Use of improper extension cord could result in a risk of fire and electric shock. If extension cord must be used, make sure:
 - a. That pins on plug of extension cord are the same number, size, and shape as those of plug on charger.
 - b. That extension cord is properly wired and in good electrical condition; and
 - c. That wire size is large enough for AC ampere rating of charger as specified below:

Cord Length (Feet)	25'	50'	100'
Cord Size (AWG)	14	14	12
NOTE: AWG = American Wire Gauge			

- Do not disassemble charger. Opening the charger will void its warranty. If charger requires service or repair during the warranty period, Contact our customer service department for help at 1-866-902-9690.

DESCRIPTION OF SYMBOLS

The following symbols are used on the product and in this manual to alert the operator of potential safety hazards. Read them carefully, and understand their meaning.



DANGER!

Indicates an imminently hazardous situation which, if not avoided, will result in death or serious injury.



WARNING!

Indicates a potentially hazardous situation which, if not avoided, could result in death or serious injury.



CAUTION!

Indicates a potentially hazardous situation which, if not avoided, may result in minor/moderate injury.



NOTICE!

Indicates a practice not related to personal injury which, if not avoided, may result in property damage.

Other Symbols

Some of the following symbols may be used on this product. Please study them and learn their meaning. Proper interpretation of these symbols will allow you to operate the product better and safer.



Look for this symbol to point out important safety precautions. It means: **Attention! Become Alert! Your Safety Is Involved.**



Read operator's manual before operating this machine. Failure to follow directions could result in serious injury.



Wear eye protection complying with ANSI Z78.1.



DANGER — Keep Hands Away from the Impeller and Auger



Keep Feet Out of Impeller and Auger



DANGER — Keep Hands and Feet Away



Recycle Symbols-- This product uses Lithium-ion (Li-ion) batteries. Local, state, or federal laws may prohibit disposal of batteries in ordinary trash. Consult your local waste authority for information regarding available recycling and/ or disposal options.

PARTS LIST

KNOW YOUR SNOW BLOWER (See Fig.1)

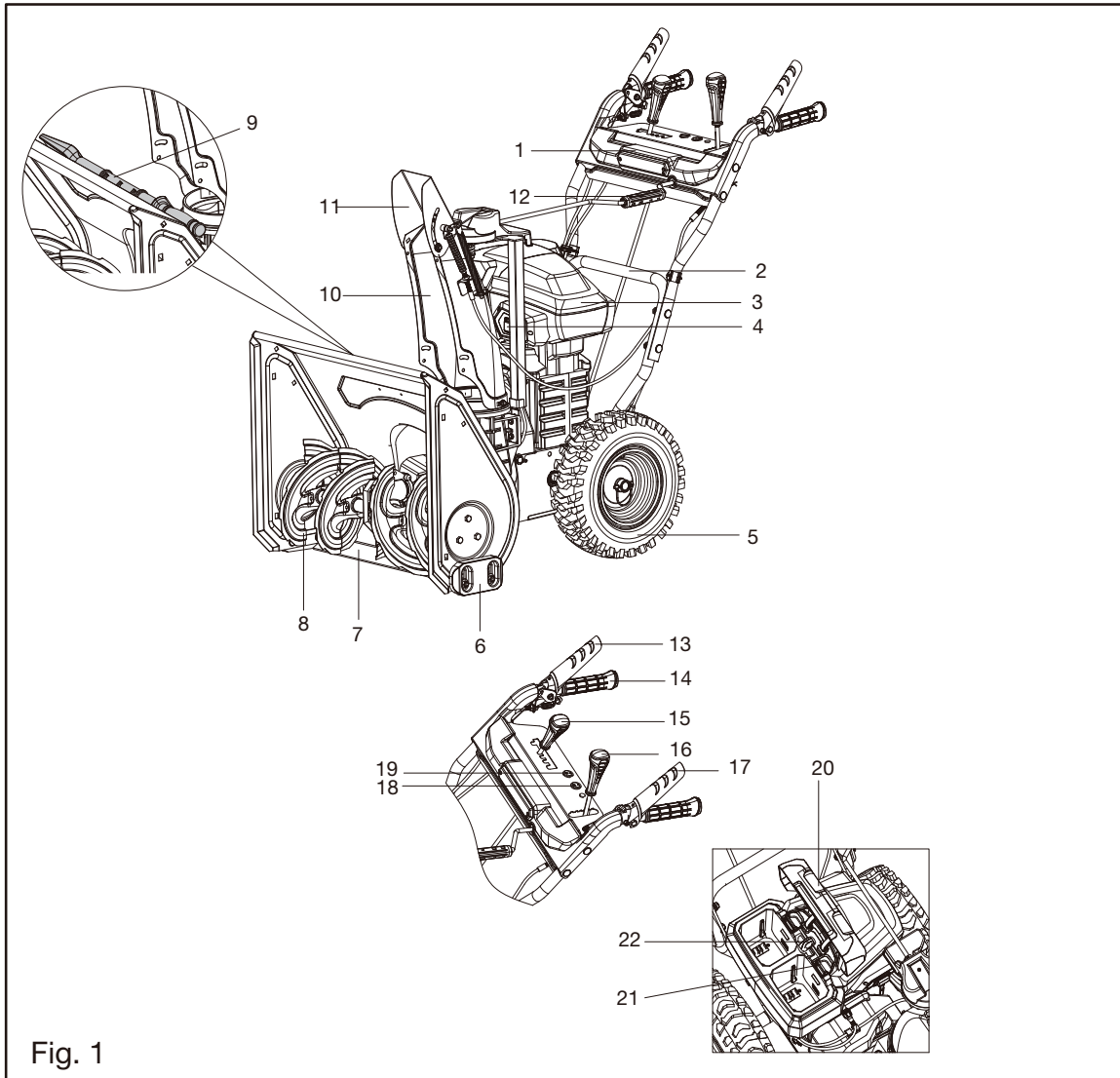

Fig. 1

- | | |
|--------------------------|----------------------------|
| 1. LED Headlight | 12. Chute Rotation Bar |
| 2. Lower Handle | 13. Auger Control Trigger |
| 3. Battery Compartment | 14. Heated Grip |
| 4. On/Off Switch | 15. Speed Shift Handle |
| 5. Wheel | 16. Chute Deflector Handle |
| 6. Skid Shoe | 17. Drive Control Trigger |
| 7. Shave Plate | 18. Heating Switch |
| 8. Auger | 19. LED Light Switch |
| 9. Clean-out Tool | 20. Battery Cover |
| 10. Snow Discharge Chute | 21. Battery-Release Latch |
| 11. Chute Deflector | 22. Safety Key |

PARTS LIST



WARNING: The safe use of this product requires an understanding of the information on the product and in this operator's manual as well as a knowledge of the project you are attempting. Before use of this product, familiarize yourself with all operating features and safety rules.

On/Off Switch

The On/Off switch must be pressed down before the motor can be started.



WARNING: The On/Off switch is safety device. Never attempt to bypass its operation.

Auger Drive Trigger

Engages and disengages the auger.

Drive Control Trigger

Engages and disengages the self-propel function.

Speed Shift Handle

Changes the self-propel speed and direction.

Chute-Rotation Handle

Rotates the chute so that the user may direct the discharged snow as desired. The handle allows the chute to rotate from left to right.

Chute-Deflector Handle

Adjusts the angle of the chute deflector and the height of the discharge stream.

LED Headlight

This feature provides extra light for increased visibility.

LED Light Button

Turns on/off the LED headlights and sidelights.

Shave Plate

Removes the last bit of snow from the surface you are clearing.

Skid Shoe

Increases the ability to maneuver the snow blower on the snow and adjusts the distance between shave plate and ground.

Battery-Release Latch

Press to release the battery.

Safety-Key

The machine is fitted with a safety key, this prevents the accidental start up of your product. The safety key has been design to totally disable the snow blower when the key is removed.

PARTS LIST

PARTS LIST

Two people should grasp the lower handle and the front part of the product at the same time and carefully lift the tool up and out of the carton. Remove any other accessories from the carton. Make sure that all items listed in the packing list are included.

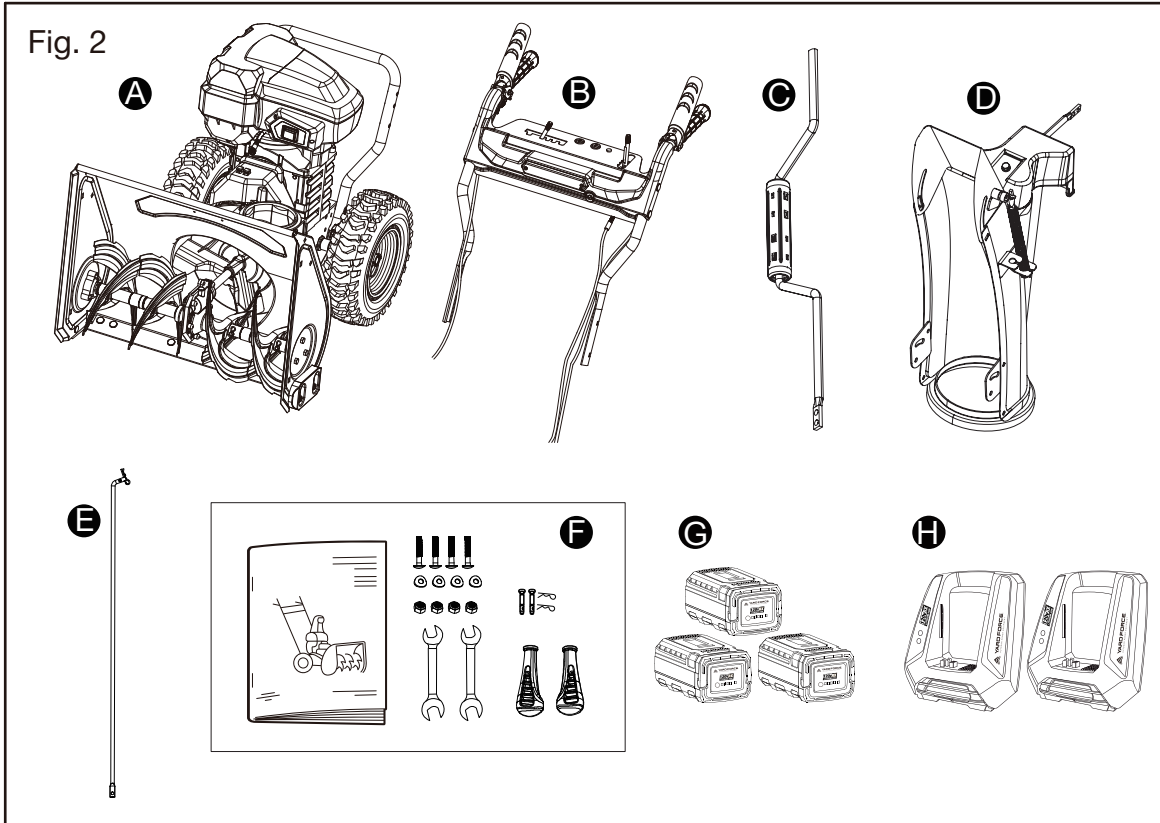

A.	Main Body	1pc
B.	Upper Handle Assembly	1pc
C.	Chute Rotation Bar	1pc
D.	Chute Assembly	1pc
E.	Speed Shift Rod	1pc
F.	Hardware Kit	
a)	Handle attachment hardware	4sets
b)	Open-end spanner	2pcs
c)	Control handle grip	2pcs
d)	Spare auger shear pin	2pcs
G.	Battery Pack	3pcs
H.	Charger	2pcs

TECHNICAL SPECIFICATIONS

Voltage	120V 
Clearing Width	24 in
Intake Height	21 in
Throwing Distance	Up to 40 ft.
Wheel Size	13 in
Operating Temperature	-4°F to 50°F (-20°C to 10°C)
Storage Temperature	32°F to 113°F (-0°C to 45°C)
Snow Blower Weight (Without battery and charger)	119 lbs (54 kg)

ASSEMBLY

WARNING: To prevent accidental starting that could cause serious personal injury, always remove the battery pack(s) from the tool when assembling parts.

WARNING: If any parts are damaged or missing, do not operate this product until the parts are replaced. Use of this product with damaged or missing parts could result in serious personal injury.

WARNING: Do not attempt to modify this tool or create accessories not recommended for use with this product. Any such alteration or modification is misuse and could result in a hazardous condition leading to serious injury.

UNPACKING

- Use two people to grasp the lower handle and the front part of the product at the same time and carefully lift the tool up and out of the carton. Remove any other accessories from the carton. Make sure that all items listed in the packing list are included.

CAUTION: Heavy object. Team lift required. At least two persons are required to be lift this snow blower out of the package.

WARNING: Do not use this product if any parts on the packing list are already assembled to your product when you unpack it. Parts on this list are not assembled to the product by the manufacturer and require customer installation. Use of a product that may have been improperly assembled could result in serious personal injury.

- Inspect the product carefully to make sure that no breakage or damage occurred during shipping.
- Do not discard the packing material until you have carefully inspected and satisfactorily operated the tool.
- If any parts are damaged or missing, please contact our customer service department for help at 1-866-902-9690.

TO INSTALL THE HANDLE ASSEMBLY

1. Lift up the upper handle assembly and slot it into the lower handle, and secure it with 4 sets handle attachment hardware. (see Fig. 3).

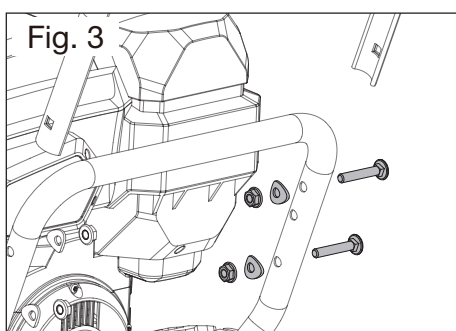

ASSEMBLY

2. Attach the auger drive control cable to the cable clamp located on the belt cover (see Fig. 4).

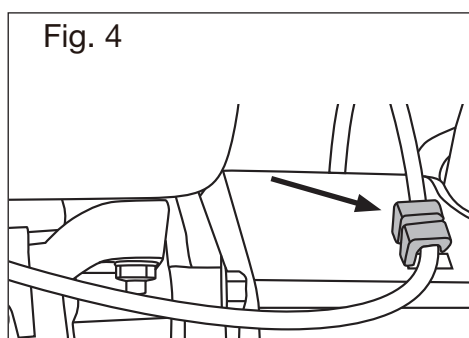

TO ASSEMBLE THE SPEED SHIFT ROD (See Fig. 5&6)

1. Remove the cotter pin from the bottom plate of the speed shift handle. (Fig. 5)
2. Attach the upper end of shift rod to the pin on the bottom plate of the speed shift handle and secure it in place with the cotter pin.
3. Remove the cotter pin from the other end of shift rod and insert the angled end into the hole on the shift lever, and secure it in place with the cotter pin. (Fig. 6)

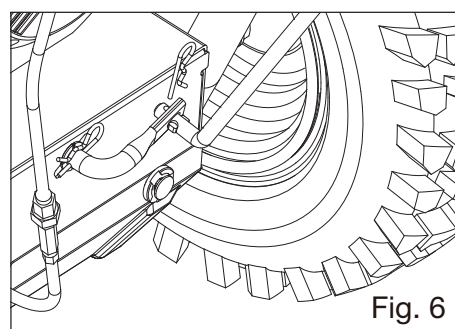
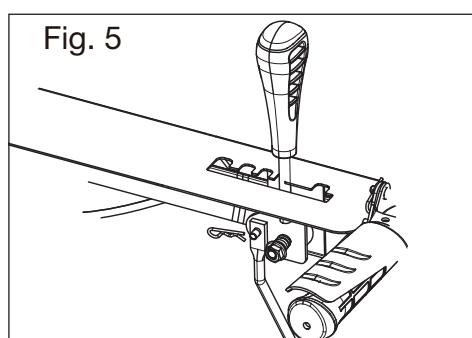

TO ASSEMBLE THE CONTROL HANDLE GRIP (See Fig. 7)

Rotate the control handle grips to the handle ends on the dash panel. Tighten each by hand.

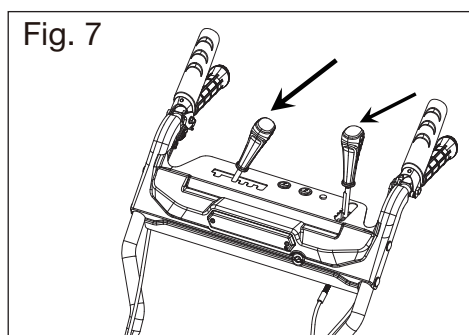

ASSEMBLY

TO INSTALL THE SNOW DISCHARGE CHUTE ASSEMBLY



WARNING: Never operate the snow blower without the complete discharge chute in place.



WARNING: Use the chute rotation handle to make sure that the chute rotates properly and that the discharge opening never crosses the operator controls.

1. Remove two bolts and metal plate from the end of chute support bar (Fig. 8B).
2. Place the chute on the machine, seat chute end (Fig. 8 C) on the chute seat (Fig. 9 A). The end of the chute support bar (Fig. 8 B) must be aligned with the seat bracket (Fig. 9 B).
3. Fix the chute support bar end (Fig. 8 B) to the seat bracket (Fig. 9 B) with the two bolts and metal plate.
4. Insert the chute rotation bar's end (Fig.10 A) to the hole in the control panel. Remove the cotter pin from the hole on chute assembly and insert the other end (Fig. 10 B) hole on chute assembly as shown (Fig. 11 A). Once inserted, secure with the cotter pin.
5. Remove the cotter pin from the bracket (Fig. 12B) of chute deflector handle and connect chute deflector control cable end (Fig. 13B) to the bracket (Fig. 12B) , and secure with cotter bin.
6. Place cable with nuts (Fig. 13 A) onto bracket (Fig. 12 A) so nuts are on each side of bracket. Check the deflector handle function and tighten nuts to secure cable

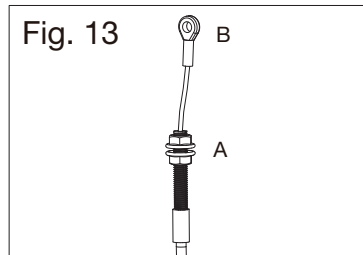
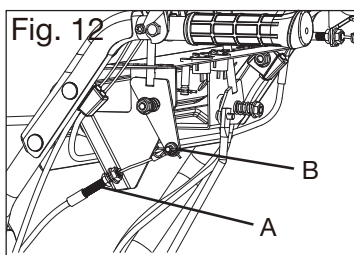
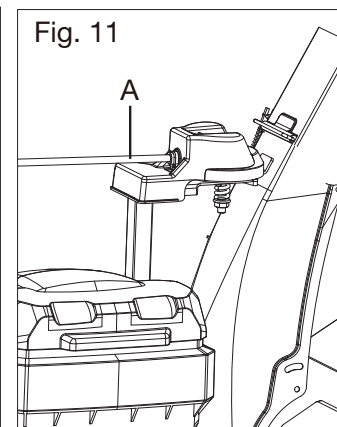
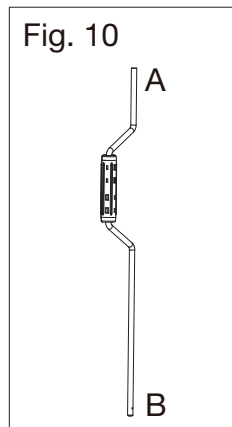
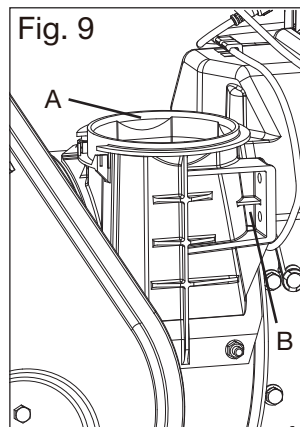
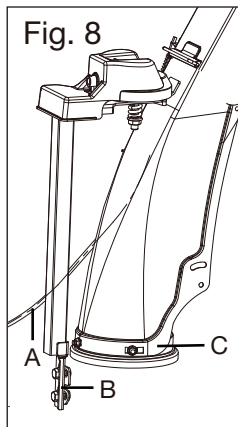

WARNING: Do not allow familiarity with this product to make you careless. Remember that a careless fraction of a second is sufficient to inflict serious injury.



WARNING: Always wear eye protection with side shields marked to comply with ANSI Z87.1. Failure to do so could result in objects being thrown into your eyes and other possible serious injuries.



WARNING: Do not use any attachments or accessories not recommended by the manufacturer of this product. The use of attachments or accessories not recommended can result in serious personal injury.

OPERATION

APPLICATION

You may use this product for purpose listed below:
Removing snow from areas such as driveways and sidewalks.

Control Panel

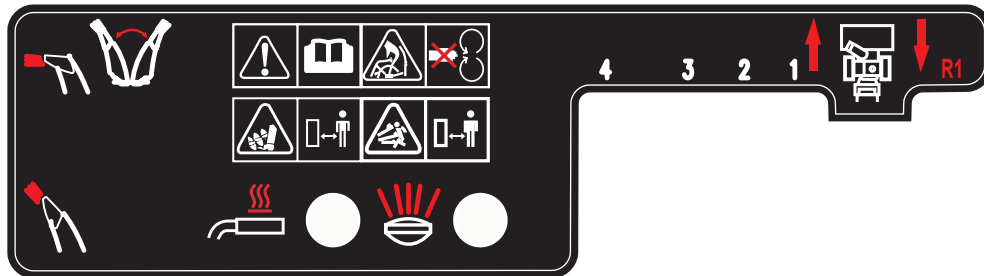

Fig. 14

Speed Shift Handle

Set the speed shift handle into any position to control speed and direction.
See Figure 14.

NOTICE: The speed is fixed when operating the snow blower with self-propel; the self-propel speed-control lever cannot change the speed while in motion. NEVER reposition the shift lever (change speeds or direction of travel) without first releasing the drive control and bringing the snow blower to a complete stop. Doing so will result in premature wear to the drive system.

Forward

There are four forward (F) speeds. Position one (1) is the slowest and position four (4) is the fastest.

Reverse

There is one reverse (R1) speed.

Auger Control Trigger

The auger control is located on the right handle. Squeeze the control trigger against the grip to engage the augers and start snow blowing action. Release to stop. See Figure 15.

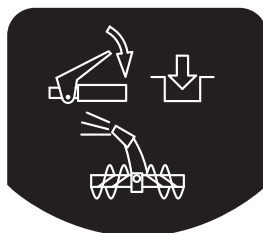

Fig. 15

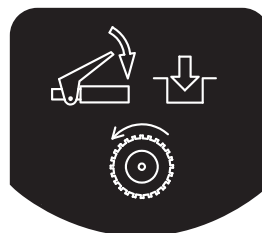

Fig. 16

Drive Control Trigger

The drive control is located on the left handle. Squeeze the control trigger against the grip to engage the wheel drive. Release to stop. See Figure 16.

Chute Rotation Bar

The chute rotation bar (Fig. 17 A) is located in front of the panel of the snow blower, while chute deflector handle (Fig. 17 B) is located on the panel.

Rotate the bar (Fig. 17 A) right or left to change the direction of snow output.

OPERATION

Move the handle (Fig.17 B) forward or backward to adjust the deflector.

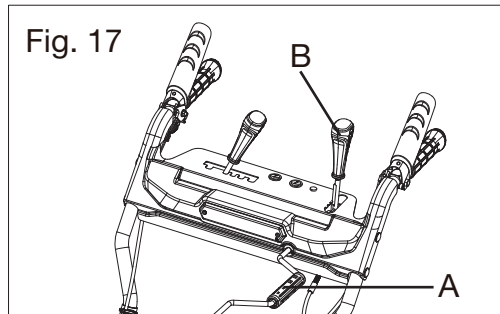

Clean-Out Tool



WARNING: Never use your hands to clear a clogged chute assembly. Shut off machine and remain behind handles until all moving parts have stopped before unlogging.

The chute clean-out tool is fastened to the top of the auger housing with a mounting clip. The tool is designed to clear a clogged chute assembly.

Skid Shoes

Position the skid shoes based on surface conditions. Adjust the shave plate lower for hard-packed snow. Adjust higher when operating on gravel or crushed rock surfaces.

Augers

When engaged, the augers rotate and draw snow into the auger housing.

Chute Assembly

Snow drawn into the auger housing is discharged out the chute assembly.

TO INSERT / REMOVE THE BATTERY PACK



Note: Batteries must be fully charged before first use.



NOTE: When not in use, 120V battery packs should be stored in an enclosed area where the temperature will not drop below -32°F (-0°C).



WARNING: If any parts are broken or missing, do not attempt to attach the battery packs to the snow blower or operate the snow blower until the broken or missing parts are replaced. Failure to do so could result in serious injury.

1. The battery cover is hinged. Raise the battery cover by lifting the side of the cover.
2. Align the grooves in the battery pack with the raised ribs in one of the battery compartments, and then insert the battery pack into the compartment (Fig.18).

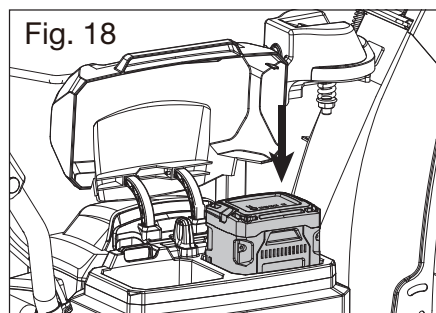

3. Push the battery pack until you hear a "click". The battery-release latch will spring up when the battery pack is securely attached.

OPERATION

4. Insert the other battery pack into the other battery compartment in the same way.
5. To remove the battery pack, depress the battery release latch to release the battery pack, and then lift it out of the compartment (Fig. 19).
6. Close the battery cover.

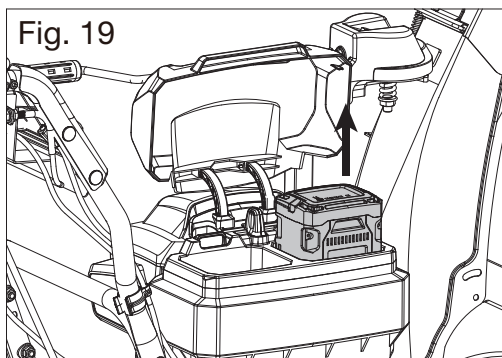

NOTICE: Make sure that the latch on the snow blower snaps into place and that the battery pack(s) are secured to the unit before starting operation.

STARTING/STOPPING THE SNOW BLOWER

- CAUTION:** Do not attempt to override the operation of the safety button. Do not rapidly turn the snow blower off and on.
- WARNING:** The operation of a snow blower can result in foreign objects being thrown into your or others' eyes, which can damage eyes severely. Always wear safety glasses while operating the snow blower or while performing any adjustments or repairs on the snow blower.
- WARNING:** Ensure that other people and pets remain at least 100' (30m) away from the snow blower when it is in use.
- WARNING:** The auger will continue to rotate for a few seconds after the snow blower is turned off. Allow the auger to stop rotating before starting it again.

To Start the Snow Blower

1. Ensure that the handle assembly is securely attached, the chute assembly is mounted properly, and the chute and chute deflector are adjusted to an appropriate position.
2. Insert the battery pack(s) to the battery compartments and close the battery cover.

NOTICE: Make sure that the latch on the snow blower "clicks" into place and that the battery pack(s) are secured to the snow blower before operation.

3. Set the on/off switch to the "on" position. (Fig. 20).
4. Squeeze the auger control trigger against the grip to start snow blowing. (Fig. 21)

NOTICE: The snow blower may not properly start if its battery temperature is -4°F (-20°C) or less. If the snow blower doesn't start, remove the battery from the snow blower and allow it to warm indoors for 10 minutes or longer. Reinstall the battery and try again.

OPERATION

To Stop the Snow Blower

1. Fully release the auger control trigger.
2. Set the on/off switch to the "off" position.

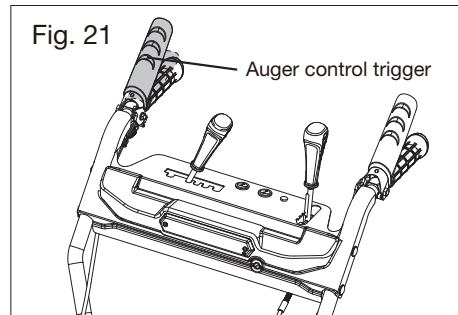
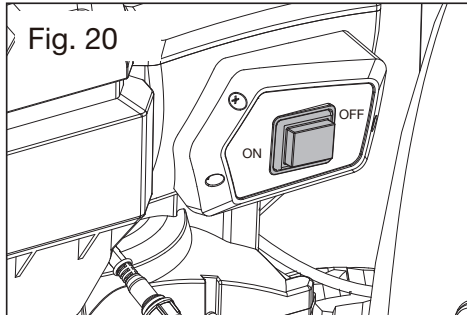

Variable-Speed Self-Propel System (Fig.22)

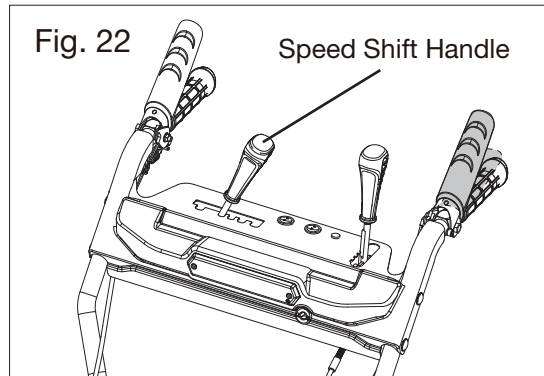

This snow blower is equipped with variable-speed self-propel capability. This system is independent of the auger ; it is not dependent on auger rotation. For example, when you have completed cleaning of the driveway, you can use the self-propel function to propel the snow blower to your storage location without activating the auger.

To operate the self-propel system:

1. Ensure the snow blower on/off switch in the "on" position.
2. Squeeze the drive control trigger against the grip to start self-propel function.
3. Release the drive control trigger to stop the self-propel function.

The self-propel system has variable speed. To change the speed of the self-propel:

1. Release the drive control trigger and stop the self-propel function.
2. Move the speed shift handle to the desired setting. (Fig. 22)
3. Squeeze and hold the drive control trigger.

To move the snow blower backward:

1. Release the drive control trigger and stop the self-propel function.
2. Move the speed shift handle to the R1 position.
3. Squeeze and hold the drive control trigger.

NOTICE: The speed is fixed when operating the snow blower with self-propel; the self-propel speed-control lever cannot change the speed while in motion. NEVER re-position the shift lever (change speeds or direction of travel) without first releasing the drive control and bringing the snow blower to a complete stop. Doing so will result in premature wear to the drive system.



OPERATION

AUGER CONTROL TRIGGER AND DRIVE CONTROL TRIGGER LINKAGE (ONE HANDLE OPERATION) (Fig. 23)

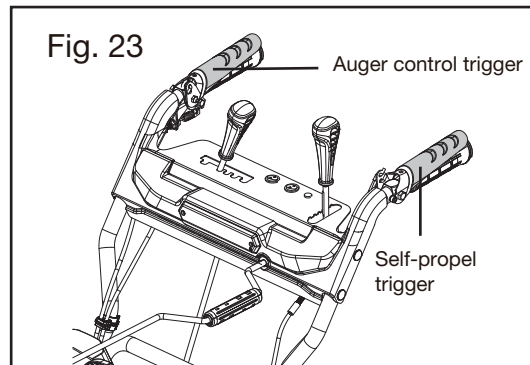

When you activate the drive control trigger and the auger control trigger at the same time, the auger control trigger will be temporarily locked. Release the auger control trigger and it will remain engaged. This one hand operation feature allows you to adjust the discharge chute direction while the auger rotates.

Releasing the drive control trigger will stop the auger rotation and self-propel function at the same time.

Adjust The Direction of Snow-Discharge Chute.

The chute can be adjusted to change both the direction and the distance of the discharged snow to assist you in moving snow away from one area and placing it in another.

The direction of snow discharge can be adjusted 90° left or right. To adjust the direction (Fig. 24 A):

1. Rotate the chute rotation bar to the left to rotate the chute to the left.
2. Rotate the chute rotation bar to the right to rotate the chute to the right.

Adjust The Chute Deflector

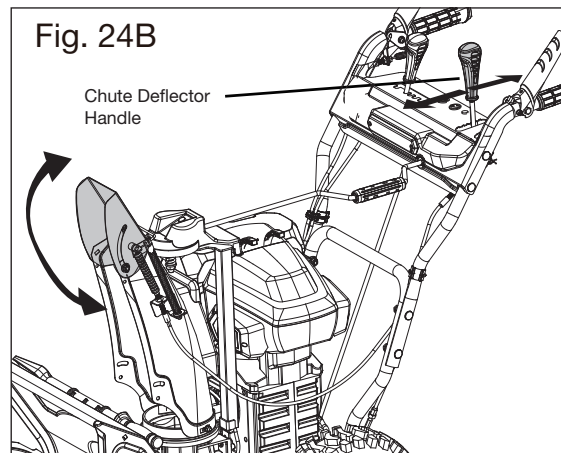
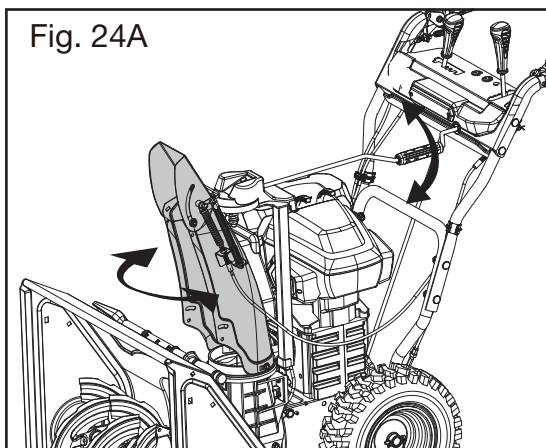

The throwing distance of the snow blower is adjusted by moving the chute deflector up or down. To increase or decrease the distance that the snow is thrown, pull the chute deflector handle backward or forward to raise or lower the chute deflector (Fig. 24 B). Once arriving at the desired chute deflector position, engage the chute deflector handle back into the locking slot.

OPERATION

LED HEADLIGHT AND HEATED GRIP OPERATION (Fig.25)

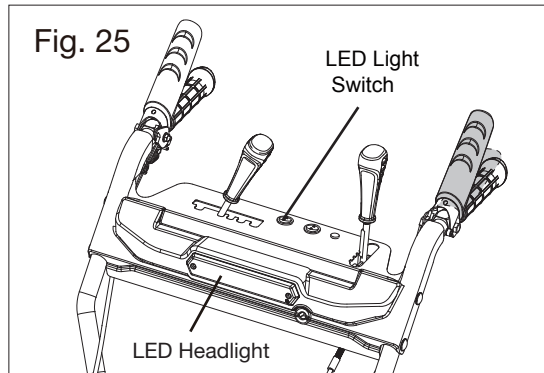

To operate the LED Headlight:

1. Set the LED light switch into the "on" position to turn on the headlight.
2. To turn off the LED headlight, set the LED light switch to the "off" position.

To operate the heated hand grips:

1. Set the heated grip switch into the "on" position to heat the grips.
2. To turn off the heated hand grips, set the heated grip switch to the "off" position.

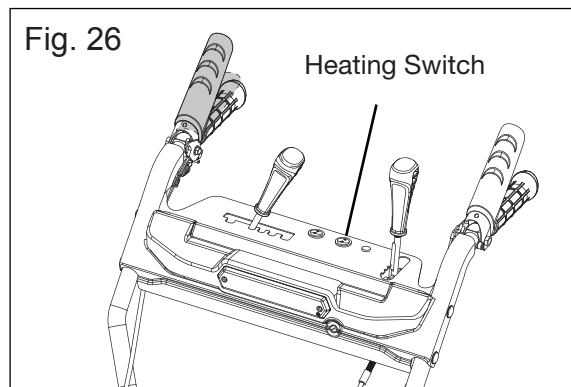

Skid Shoe Adjustment

The space between shave plate and the ground can be adjusted. See Figure 27.

- For close snow removal on a smooth surface, set the skid shoes higher on the auger housing to decrease shave plate height.
- Set the skid shoes in the middle or lower on the auger housing to increase shave plate height when the area being cleared is uneven, such as a gravel driveway.

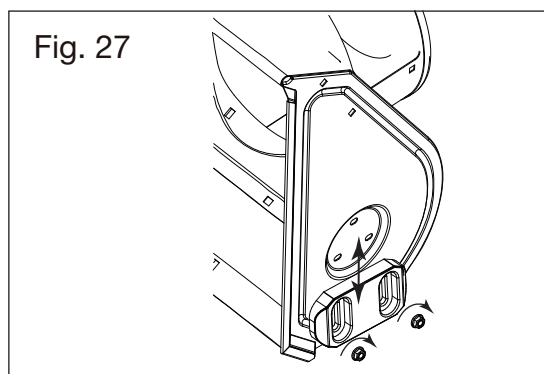

OPERATION

To adjust the skid shoes:

1. Loosen the four hex nuts (Two on each side) and carriage bolts. Move skid shoes to desired position.
2. Make certain the entire bottom surface of skid shoe is against the ground to avoid uneven wear on the skid shoes.
3. Retighten nuts and bolts securely.



NOTICE: All the LED lights will turn off automatically if the snow blower is not being operated within 5 minutes.

SNOW BLOWER OVERLOAD PROTECTION

To prevent overload conditions, do not try to remove too much snow at one time. Slow down your pace or decrease the width of the snow-clearing swath. Your snow blower has built-in overload-sensing elements. When the snow blower is overloaded, the motor will decrease the speed automatically and you will hear the volume of the motor decrease. Slow down your pace or narrow the clearing width, after which the motor will automatically resume its normal speed. If this remedy does not solve the overload situation, the sensor will shut off the motor automatically and the LED indicator on the battery pack will flash orange. Set the on/off switch to the "off" position. Remove the battery pack(s) from the snow blower and wait 10 seconds to be sure all moving parts have stopped. Next, check to see if there is snow or ice stuck in the auger and chute. If necessary, follow instructions for "**CLEARING A CLOGGED CHUTE**".

CLEARING A CLOGGED CHUTE



WARNING: Hands coming in contact with the rotating auger inside the chute is the most common cause of injury associated with snow blowers. Never use your hand to clean out the chute.



WARNING: Never reach into the discharge chute or place any body part in front of the snow blower when the unit is operating or when the battery pack(s) are installed. Always ensure all moving parts have stopped and the battery pack(s) have been removed before clearing any obstructions. Failure to follow these instructions can result in serious personal injury.

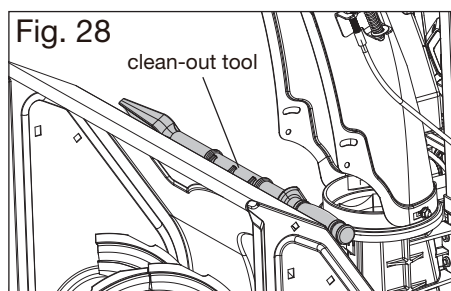

To Clear the Chute:

1. Set the on/off switch to the "off" position.
2. Remove the battery pack(s) or safety key from the battery compartment.
3. Wait 10 seconds to be sure the auger has stopped rotating.
4. Always use the chute clean-out tool which is attached to the machine as an accessory. **DO NOT USE YOUR HAND** (Fig.28).

OPERATION

BATTERY PACK OPERATION

Battery Pack Y0L120BAT2.5 (See Fig. 29)

1. Lift handle
2. Main housing
3. Indicator button
4. Green LED lights
5. Red LED lights

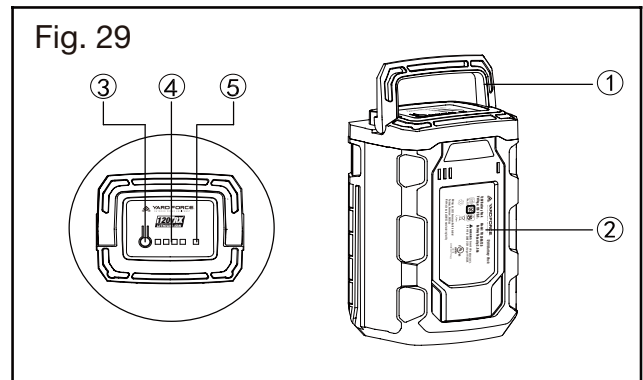

Battery Pack Operation (See Fig. 30)

1. When you push the power indicator button, the green LED lights will show the power remaining. (see Fig. 30-1)
2. When the battery pack over discharges or remains very low power, the red LED light will flash. (see Fig. 30-2)
3. When the battery pack temperature is exceeded, the red LED light will flash. Cool it down for 10~20 minutes. (see Fig. 30-2)
4. When there is fault with the battery pack, the red LED light will flash. (see Fig. 30-2)
5. Once the battery pack is correctly located in the charger, the 4 green LED lights of the battery pack will flash LED lights to indicate the charging process. At the same time the green LED light of the charger will flash continuously during normal charging, while the red LED light is still on. (see Fig. 30-3)

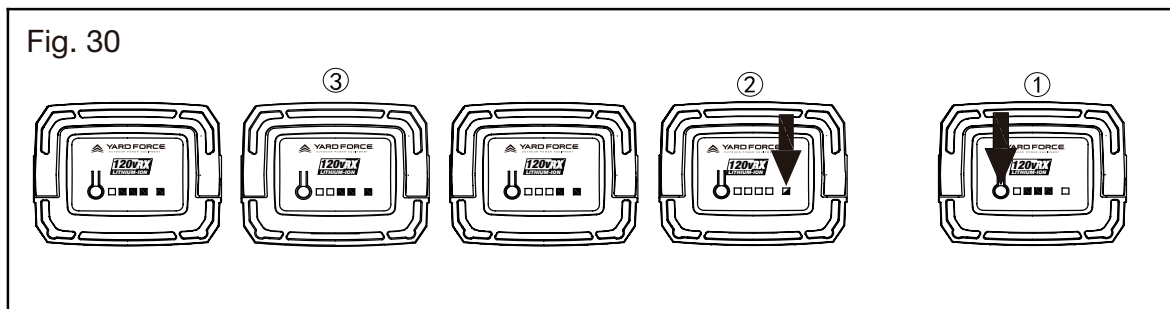

Charger Operation(See Fig. 31-32)

Note:

- The battery pack is supplied partially charged. To ensure the best performance, charge the battery completely before first use.
- Make sure the main voltage is the same as rating label which is located on the charger.
- Remove the battery pack from the charger after it has been fully charged

1. Connect the charger to a power supply. The red LED light on the charger will be on.
2. To insert the battery pack into the charger, align the grooves on the battery pack with the raised ribs in the opening of the charger. Then press the battery pack downward with a moderate force. (There is a carrying handle at the top of the battery pack. Lift the handle up for easy-transporting.)
3. Once the battery pack is correctly located in the charger, the green LED light of the charger will flash continuously during normal charging, while the red LED light is still on.
4. When charging is complete, both green and red LED light of the charger will be on.
5. If you encounter one of following kind of situations, the red LED light of charger will flash.
 - Wrong communication. It refers to poor connection between charger and battery pack.
 - Faulty with battery pack. It need be repaired by the customer service center.

OPERATION

Wall-mount holes

The charger has hanging holes for convenient storage. Install two screws horizontally in the wall 10.7cm apart. Use screws sufficiently strong to hold the combined weight of the charger and battery pack.

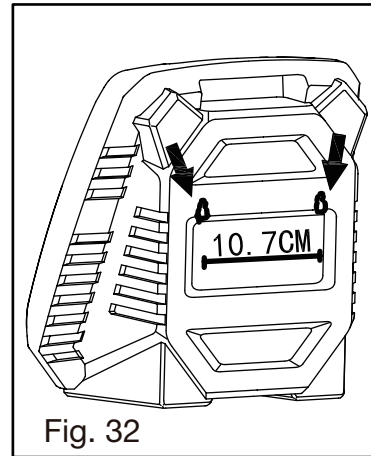
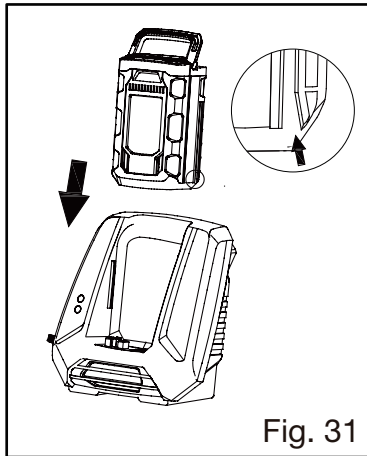

Safety Key

The machine is fitted with a safety key, this prevents the accidental start up of your cordless snow blower. The safety key has been designed to totally disable the snow blower when the key is removed.

If the safety key is lost or broken, please call the Yard Force service hot-line at 866-902-9690.

OPERATING TIPS



DANGER: Never use a snow blower on frozen lakes, rivers, or similar surfaces. Death or serious injury could occur if the ice breaks.



DANGER: Never use the snow blower on a rooftop or other unstable surface, which can result in death or serious personal injury.



WARNING: Do not use snow blower on ice, which can cause the operator to slip and fall, resulting in serious personal injury.



WARNING: Do not wear loose clothing, scarves, or jewelry. They can be caught in moving parts and cause death or serious personal injury.



WARNING: Keep all snow discharge pointed away from all electrical devices to reduce the risk of electrocution or electric shock.



WARNING: Never point the snow blower or discharge chute in the direction of people or pets. Thrown snow or other objects can cause serious personal injuries.



WARNING: Make sure that the area to be cleared is free of stones, sticks, wires, gravel, and other objects that could be accidentally thrown by the snow blower in any direction and cause serious personal injury to the operator and others.

If the unit comes in contact with any type of obstruction or debris during use, stop the snow blower, remove the battery pack(s), remove the obstruction, and inspect the unit carefully for damage before proceeding.

OPERATION



WARNING: Never reach into the discharge chute or place any body part in front of the snow blower when the unit is operating or when the battery pack(s) are installed. Always ensure all moving parts have stopped and the battery pack(s) have been removed before clearing any obstructions. Failure to follow these instructions can result in serious personal injury.

- Take notice of the direction of the wind before beginning. When possible, discharge snow in the same direction as the wind to prevent snow from being thrown back into your face.
- Some parts of the snow blower can freeze under extreme weather conditions. Do not attempt to operate the unit with frozen parts.
- When finished, allow the motor to run for an additional few minutes to prevent moving parts from freezing, then turn the chute rotation handle back and forth several times to free it from any ice buildup. Make sure to clean off any snow and ice from the product.
- In snowy and cold conditions, some controls and moving parts may freeze. Do not use excessive force when trying to operate frozen controls. If you have difficulty operating any control or part, start the machine as “**STARTING/STOPPING THE SNOW BLOWER**” section shown and let it run for a few minutes.

MAINTENANCE AND STORAGE



WARNING: To avoid serious personal injury, always remove the battery pack(s) from the snow blower before cleaning or performing any maintenance.



WARNING: When servicing, use only identical replacement parts. Use of any other parts may create a hazard or cause product damage. To ensure safety and reliability, all repairs should be performed by a qualified service technician.



NOTICE: Periodically inspect the entire product for damaged, missing, or loose parts such as screws, nuts, bolts, caps, etc. Tighten securely all fasteners and caps and do not operate this product until all missing or damaged parts are replaced.

GENERAL MAINTENANCE

Avoid using solvents when cleaning plastic parts. Most plastics are susceptible to damage from various types of commercial solvents and may be damaged by their use. Use clean cloths to remove dirt, dust, oil, grease, etc.



WARNING: Do not at any time let brake fluids, gasoline, petroleum-based products, penetrating oils, etc. come in contact with plastic parts. Chemicals can damage, weaken, or destroy plastic which can result in serious personal injury.



WARNING: Before lubricating, repairing, or inspecting, disengage and turn off all controls. Wait until all moving parts have come to a complete stop. Always remove the battery pack(s) when servicing or transporting the snow blower. Always protect your hands by wearing gloves when performing any maintenance on the snow blower auger or shave plate.

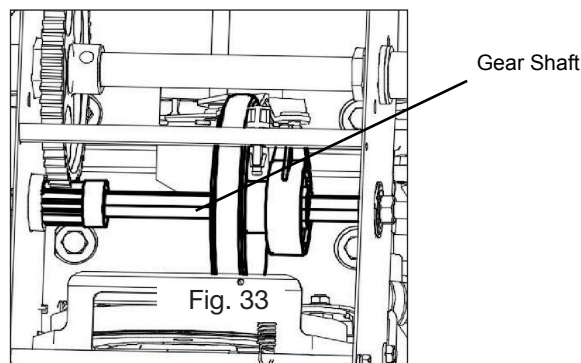

Gear Shaft

The gear (hex) shaft should be lubricated at least once a season or after every 25 hours of operation.

1. Remove the lower frame cover by removing the two screws which secure it.
2. Apply a light coating of an all-weather multi-purpose grease to the hex shaft. See Fig. 33.

IMPORTANT: Avoid oil spillage on rubber friction wheel and aluminum drive plate.

Wheels

At least once a season, remove both wheels. Clean and coat the axles with a multipurpose automotive grease before reinstalling wheels.

Chute Directional Control

Once a season, the joystick should be lubricated with machine oil.

MAINTENANCE AND STORAGE

Auger Shaft

At least once a season, remove the shear pins on auger shaft. Spray lubricant inside shaft, around the spacers. Also lubricate the flange bearings found at either end of the shaft. See Figure 34.

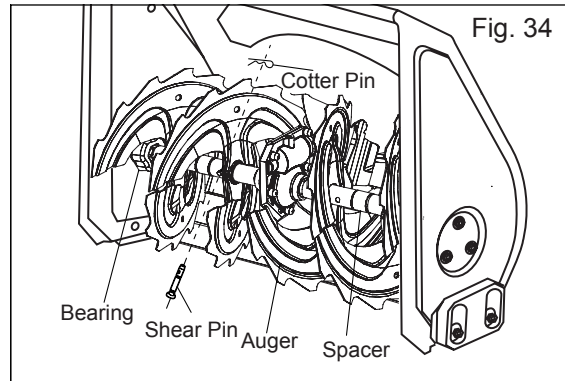

Gear Case

The auger gear case has been filled with grease and sealed at the factory. If disassembled for any reason, lubricate with three ounces of new grease.



NOTE: Do not over fill the gear case. Damage to the seals could result. Be sure the vent plug is free of grease in order to relieve pressure.

Shave Plate and Skid Shoes

The shave plate and skid shoes on the bottom of the snow blower are subject to wear. They should be checked periodically and replaced when necessary.

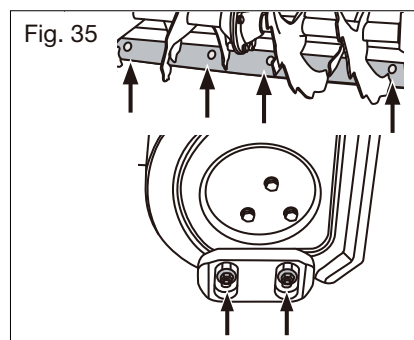

To remove skid shoes:

1. Remove the four carriage bolts and hex flange nuts which secure them to the snow blower.
2. Reassemble new skid shoes with the four carriage bolts (two on each side) and hex flange nuts. See Figure 35.

To remove shave plate:

1. Remove the carriage bolts and hex nuts which attach it to the snow blower auger housing.
2. Reassemble new shave plate, making sure heads of carriage bolts are to the inside of housing. Tighten securely. See Figure 35.

Auger Belt Replacement

To remove and replace the auger belt, proceed as follows:

1. Carefully pivot the snow blower up and forward so that it rests on the auger housing. Remove the bottom cover from the underside of the snow blower by removing the hardware that secures it. See Figure 36.

MAINTENANCE AND STORAGE

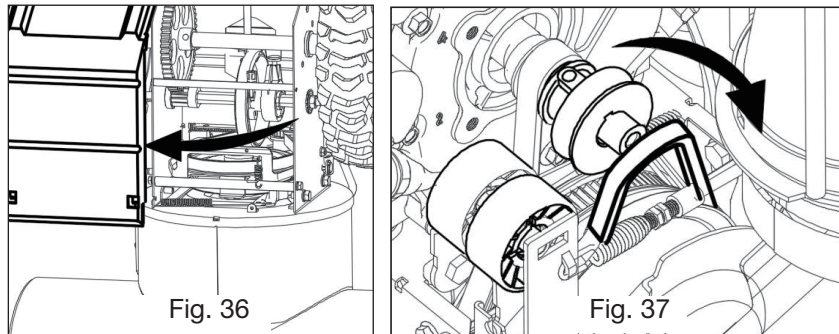

2. Roll the auger belt off the motor pulley. See Figure 37.
 - a. Loosen and remove the shoulder screw which acts as a belt keeper.
 - b. Unhook the support bracket spring from the frame. See Figure 38.

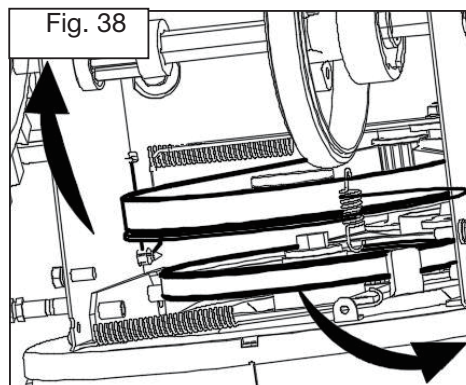

3. Remove the belt from around the auger pulley, and slip the belt between the support bracket and the auger pulley. Reassemble auger belt by following instructions in reverse order.



NOTE: Do NOT forget to reinstall the shoulder screw and reconnect the spring to the frame after installing a replacement auger belt.

Augers

- The auger are secured to the spiral shaft with two shear pins and cotter pins. If the auger should strike a foreign object or ice jam, the snow blower is designed so that the pins may shear. See Figure 39.

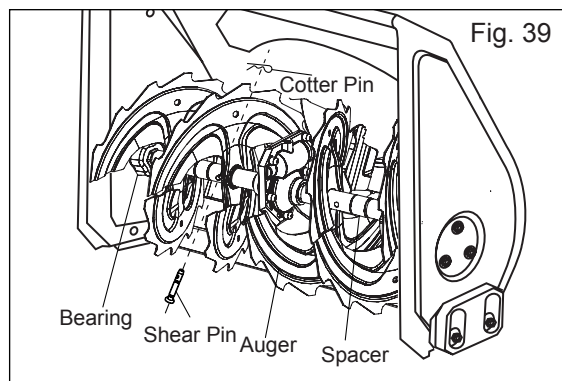

MAINTENANCE AND STORAGE

- If the augers will not turn, check to see if the pins have sheared. One set of replacement shear pins has been provided with the snow blower. When replacing pins, spray an oil lubricant into shaft before inserting new pins.

Control Cable Adjustment

Note: The drive system consists of pulleys, a belt, and a cable linking the transmission to the drive handle. As these components wear, or if the belts are adjusted or replaced, cable adjustment may be needed. To adjust the cable perform the following:

1. Locate the adjuster on the control cable.
2. Loosen the locking nut with a wrench (not supplied).
3. Hold the upper bolt and turn the stop nut clockwise to shorten the cable, counterclockwise to lengthen the cable.
4. Turn on the snow blower and test the function of the control handles.
5. Once operating correctly, tighten the locking nut on the adjuster.

Tire Pressure

Before operating, check the pressure and if necessary set between 15 psi and 20 psi (you can also refer to the specifications printed on the tire). If the tire pressure is not equal in both tires, the unit may pull to one side or the other.

STORING THE SNOW BLOWER



CAUTION: Ensure that all melted snow that may drip from the snow blower is properly wiped up to prevent a slip and fall hazard.

- Remove the battery pack(s) and store in a secure location out of the reach of children.



NOTE: When not in use, a 120V battery should be stored in an enclosed area where the temperature will not drop below -32°F (-0°C).

Before storage, wipe any moisture, dirt, or debris from the battery area.

- Wipe the snow blower with a clean dry cloth.
- Check all nuts, bolts, knobs, screws, etc., for tightness.
- Inspect moving parts for damage, breakage, and wear. Have repairs made on any damaged or missing parts.
- Store the snow blower in a clean, dry, enclosed place out of the reach of children.
- Do not store near corrosive materials such as fertilizer or rock salt.

TROUBLESHOOTING

IF THESE SOLUTIONS DO NOT SOLVE THE PROBLEM CONTACT YOUR AUTHORIZED SERVICE DEALER.

PROBLEM	CAUSE	SOLUTION
Snow blower is not starting.	<ol style="list-style-type: none"> 1. Battery charge is low. 2. Battery is not inserted 3. Safety-key is not inserted 4. The auger is frozen by snow or ice. 5. The battery is overheated. The LED indicator on the battery flashes orange or shines red. 	<ol style="list-style-type: none"> 1. Recharge the battery. 2. Completely insert the battery. 3. Insert the safety key. 4. Turn off machine and remove snow or ice. 5. See the section "BATTERY HIGH-TEMPERATURE PROTECTION" in this manual.
The machine does not run or does not run continuously.	<ol style="list-style-type: none"> 1. The battery pack is low on charge. 2. The battery pack is not fully seated. 3. The battery pack is over or under the appropriate temperature range. 4. Overload protection stopped the motor. 5. There is moisture on the leads of the battery pack. 6. The battery pack is damaged. 7. There is another electrical problem with the machine. 	<ol style="list-style-type: none"> 1. Charge the battery pack. 2. Ensure that the battery pack is inserted all the way into the housing. 3. Move the battery pack to a place where it is dry and the temperature is between 5°C (41°F) and 40°C (104°F). 4. Release the trigger, then press the trigger switch. 5. Remove and allow battery pack to dry or wipe it dry. Wipe dry any moisture in battery compartment. 6. Replace the battery pack. 7. Contact an Authorized Service center or Yard Force Customer Support.
The machine does not reach full power.	<ol style="list-style-type: none"> 1. The battery pack charge capacity is too low. 2. The air vents are blocked. 	<ol style="list-style-type: none"> 1. Remove the battery pack from the machine and fully charge the battery pack. 2. Clean the air vents.
The machine is producing a beeping sound.	<ol style="list-style-type: none"> 1. The battery pack is low on charge. 2. The machine is overloaded. 3. There is another problem with the machine. 	<ol style="list-style-type: none"> 1. Charge the battery pack. 2. Walk at a slower pace while clearing snow or break up a large pile of snow before clearing it. 3. Attempt the other troubleshooting actions, if the alarm still sounds, contact Yard Force Customer Support or an authorized service center.
The machine runs, but the machine discharges snow poorly or not at all.	<ol style="list-style-type: none"> 1. The machine is moving too fast to clear the snow. 2. You are trying to remove too much snow per swath. 3. You are trying to remove extremely heavy or wet snow. 4. The discharge chute is plugged. 5. The auger/impeller drive belt is loose or is off the pulley. 6. The auger/impeller drive belt is worn or broken. 	<ol style="list-style-type: none"> 1. Shift the machine into a lower gear. 2. Reduce the amount of snow removed per swath. 3. Do not overload the machine with extremely heavy or wet snow. 4. Unclog the discharge chute. 5. Install and/or adjust the auger/impeller drive belt. 6. Replace the auger/impeller drive belt.

TROUBLESHOOTING

The discharge chute handle does not lock into place or does not move.	<ol style="list-style-type: none"> 1. The discharge-chute cable is not properly adjusted. 	<ol style="list-style-type: none"> 1. Adjust the discharge-chute cable.
The machine does not properly clear the snow off the surface.	<ol style="list-style-type: none"> 1. The skids and/or scraper are not properly adjusted. 2. The pressure in the tires is not equal. 	<ol style="list-style-type: none"> 1. Adjust the skids and/or the scraper. 2. Check and adjust the pressure in both tires.
The battery pack loses charge quickly.	<ol style="list-style-type: none"> 1. The battery pack is over or under the appropriate temperature range. 2. The machine is overloaded. 	<ol style="list-style-type: none"> 1. Move the battery pack to a place where it is dry and the temperature is between 5°C (41°F) and 40°C (104°F). 2. Move at a slower pace or reduce the amount of snow removed per swath.
The battery charger is not working.	<ol style="list-style-type: none"> 1. The battery charger is over or under the appropriate temperature range. 2. The outlet that the battery charger is plugged into does not have power. 	<ol style="list-style-type: none"> 1. Unplug the battery charger and move it to a place where it is dry and the temperature is between 5°C (41°F) and 40°C (104°F). 2. Contact your licensed electrician to repair the outlet.
The LED indicator light on the battery charger is red.	<ol style="list-style-type: none"> 1. The battery charger and/or battery pack are not connected. 	<ol style="list-style-type: none"> 1. Ensure the battery is properly seated in the charger.
The LED indicator light on the battery charger is blinking red.	<ol style="list-style-type: none"> 1. There is an error in the communication between the battery pack and the charger. 2. Fault with battery pack or charger. 	<ol style="list-style-type: none"> 1. Remove the battery pack from the battery charger, unplug the battery charger from the outlet, and wait 60 seconds. Plug the battery charger into the outlet again and place the battery pack on the battery charger. If the LED indicator light on the battery charger is still blinking red, repeat this procedure again. If the LED indicator light on the battery charger is still blinking red after 2 attempts, Contact Yard Force Customer Support. 2. Contact Yard Force Customer Support.

WARRANTY

YARD FORCE LIMITED WARRANTY STATEMENT

YARD FORCE LIMITED WARRANTY

Product Warranty

Please keep your original purchase receipt in a safe place as proof of purchase. Warranty coverage for This product must be verified by the original purchase receipt. The warranty period begins on the day the product was purchased from an authorized retailer of Yard Force products. Warranty coverage only applies to the original purchaser and is not transferable. Warranty coverage is only provided on products purchased and used in the USA and Puerto Rico from authorized Yard Force retailers. Products purchased or used outside of the USA and Puerto Rico are not covered by this warranty.

(5) Five-Year Limited Warranty – Snow Blower

(3) Three-Year Warranty from The Date of Purchase – Battery and Charger

The YF120vRX24-SB has a Five-Year Limited Warranty and 120vRX Battery Pack and Charger has a three-year Limited Warranty from the date of purchase against manufacturer defects for residential use only. Commercial use voids the warranty. This warranty does not cover accidental damage, unreasonable use, normal wear and tear, neglect or non-compliance with the Operating, Safety and Maintenance Instructions. All service, outside of normal maintenance as described in this manual, must be done by an authorized service technician. Any unauthorized service or changes to the original configuration of this product will void the warranty. All parts and accessories used on and with this product must be manufacturer/or and authorized by Merotec Inc.

(90) Ninety-Day Warranty – Accessories

The accessories included with the YF120vRX24-SB; including the knobs, hitch pins, tires, etc., and other similar parts are warranted against manufacturer defects for residential use only for a period of 90 days from date of purchase.

Warranty does not cover loss of use or other consequential damages arising from any of the above, nor does it cover repairs made or attempted by unauthorized persons. This warranty is void if the product is used for commercial, rental or industrial purposes. Certain parts, attachments and accessories are subject to normal wear and tear and are excluded from the warranty.

Service and Warranty Claims Process

Contact the Yard Force Customer Service toll-free at **(866) 902-9690 Monday-Friday between 8:30 AM and 5:00 PM Eastern Time** for service and warranty support.

Yard Force USA Service Support agents can help you troubleshoot problems over the phone to get you back up and running as quickly as possible. In the situation where service or warranty inspection is needed, please follow these steps:

1. Contact Yard Force Customer Service at **(866) 902-9690 or support@merotecusa.com Monday-Friday between 8:30 AM and 5:00 PM Eastern Time.**
2. Send in proof-of-purchase and serial number (if applicable) to confirm warranty coverage.
3. If service or a warranty evaluation is requested, Yard Force USA will provide an RGA number that should be used in all communications with Yard Force USA and if necessary, a list of local authorized service centers to bring your lawn mower to for evaluation and repair.
4. All shipments to Yard Force USA must have an RGA number. Any shipment received that does not have an RGA number clearly marked on the outside of the box will be refused.
5. All shipments must be sent pre-paid; Yard Force USA does not pay for any shipping or transportation costs for service or warranty evaluation. Yard Force USA is not responsible for any packages that are lost by carrier. We recommend that shipments are made by a carrier that provides tracking and delivery confirmation.

For more information or to ask questions, please call toll-free (866) 902-9690 or support@merotecusa.com Monday-Friday between 8:30 AM and 5:00 PM Eastern Time.



Need Help?

Please do not return the product to your place of purchase yet. We're here to help and take care of all your needs.

Contact our customer service department for help with:

- Product assembly or use
- Missing or damaged parts
- Troubleshooting
- Replacement parts and accessories

You can submit a support request by scanning the QR code on this page, or by visiting:
www.YardForceUSA.com/contact-support

Scan Code to connect with Yard Force Support



1-866-902-9690



www.YardForceUSA.com

Register your product today to maintain warranty coverage and stay up to date with information on the use, care, maintenance and service of your product.

Register online today at:

www.yardforceusa.com/product-registration



Merotec Inc.
3655 Kennesaw North Industrial Parkway
Kennesaw, GA 30144
Copyright © 2022 Merotec Inc.

Made in China at a SUMEC manufacturing facility.

Part Number: YF120vRX24-SB-MAN-A
2204